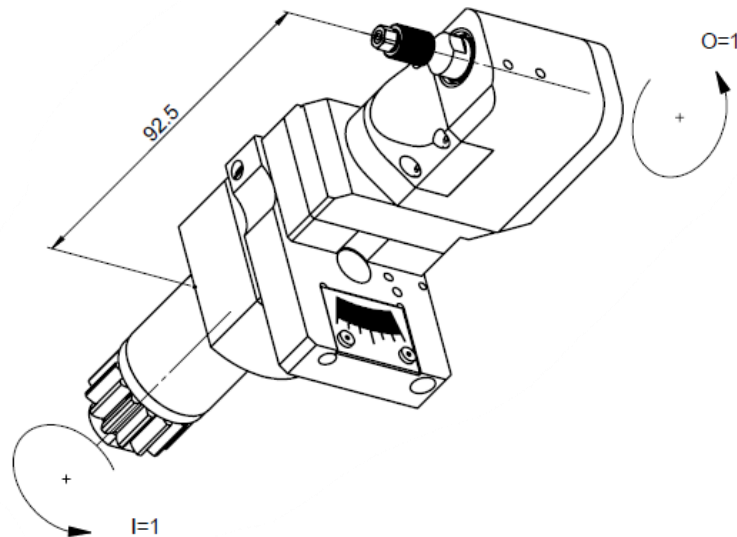

CITIZEN5-LSH035-L

Machine: CITIZEN

Type: L12-VII

Emplacement, N°: Coulisse linéaire – T10

Travail sur: Broche principale

Type de travail: n_{max}: 10'000 [rpm]i (n_i / n_o): 1 / 1

Attachement: Arbre Ø3.5 mm

Sans refroidissement

Infos:

- Fraise Ø_{max} 12 mm
- Largeur de fraise : max 10 mm
- Inclinaison max. 10° (7.5 avec une fraise de Ø10 mm et 5° avec une de Ø12 mm)

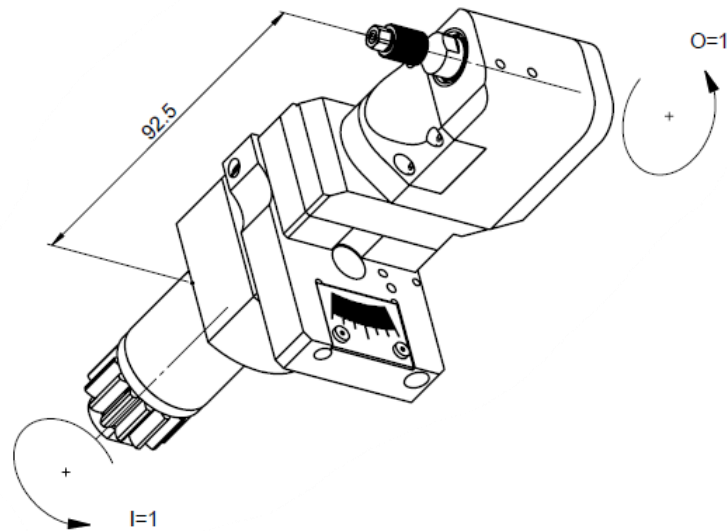
CITIZEN5-LSH035-L

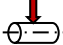
Machine: CITIZEN
Type: L12-VII
Location, N°: Gangtool – T10
Work on: Main spindle
Type of work: 
n_{max}: 10'000 [rpm]
i (n_i / n_o): 1 / 1
Attachement: Shaft Ø3.5mm

Without coolant

Infos:

- Mill Ø_{max} 12 mm
- Width of mill cutter: max 10 mm
- Slope max. 10° (7.5° with a Ø10 mm tool and 5° with a Ø12 mm)

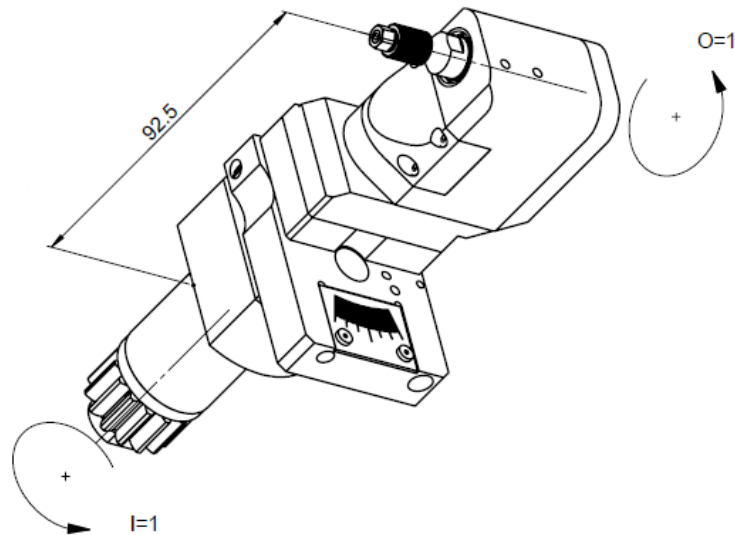
CITIZEN5-LSH035-L

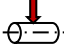
Maschine: CITIZEN
Typ: L12-VII
Position, N°: Vertikalhalter – T10
Arbeit über: Hauptspindel
Arbeitstyp: 
 n_{max} : 10'000 [rpm]
 i (n_i / n_o): 1 / 1
Befestigung: Achse Ø3.5mm

Ohne Kühlmittel

Infos:

- Fräser Ømax 12mm
- Breite von Fräser: max 10 mm
- Neigungswinkel Max. 10° (7.5° mit ein Ø10 mm Fräser und 5° mit ein Ø12 mm)

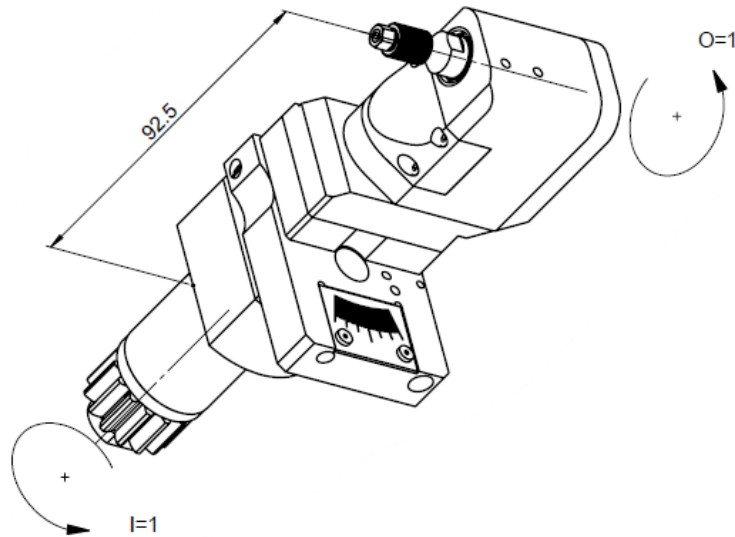
CITIZEN5-LSH035-L

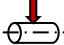
Macchina: CITIZEN
Tipo: L12-VII
Posizione, N°: Slitta lineare – T10
Lavoro al: Mandrino principale
Tipo di lavoro: 
 n_{max} : 10'000 [rpm]
 i (n_i / n_o): 1 / 1
Ataccamento: Codolo Ø3.5 mm

Senza refrigerante

Informazioni:

- Frese \varnothing_{max} 12 mm
- Larghezza di frese : 10 mm
- Inclinazione max. 10° (7,5° con un utensile Ø10 mm e 5° con un Ø12 mm)