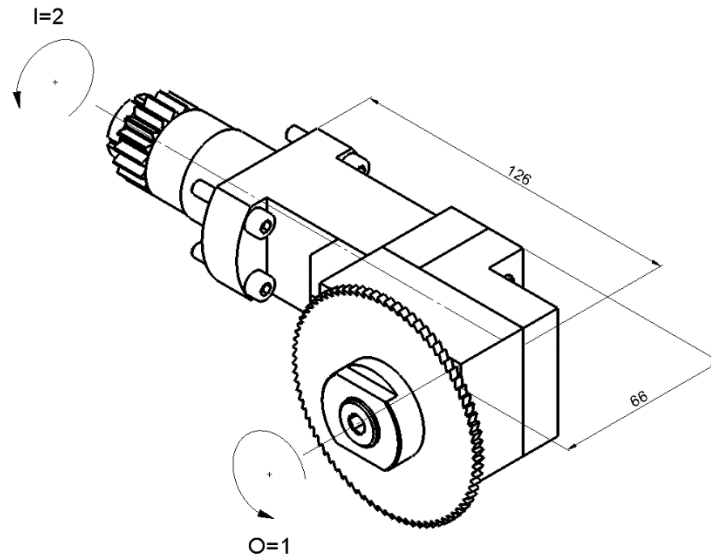

BSS122

Machine: CITIZEN Cincom

Type: L20E

Emplacement, N°: T07 / T08 / T09 / T10

Travail sur: Broche principale et Broche de reprise

Type de travail: n_{max}: 1'000 [rpm]i (n_i / n_o): 2 / 1

Attachement: Arbre Ø 22

Sans refroidissement

Infos:

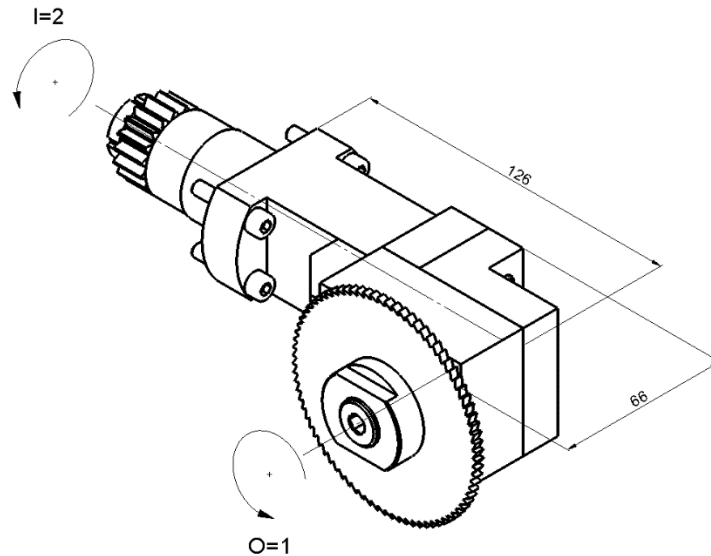
BSS122

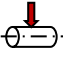
Machine: CITIZEN Cincom
Type: L220X
Location, N°: T07 / T08 / T09 / T10
Work on: Main spindle and Back spindle
Type of work: 
 n_{max} : 1'000 [rpm]
 $i (n_i / n_o)$: 2 / 1
Attachement: Arbor \varnothing 22
Without coolant
Infos:

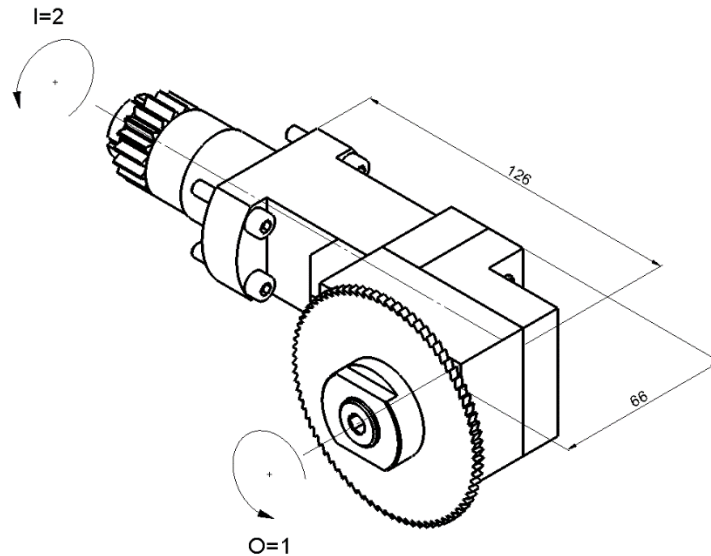
BSS122

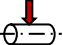
Maschine: CITIZEN Cincom
Typ: L220X
Position, N°: T07 / T08 / T09 / T10
Arbeit über: Hauptspindel und Abgreifspindel
Arbeitstyp: 
 n_{max} : 1'000 [rpm]
 $i (n_i / n_o)$: 2 / 1
Befestigung: Welle \varnothing 22
Ohne Kühlmittel
Infos:

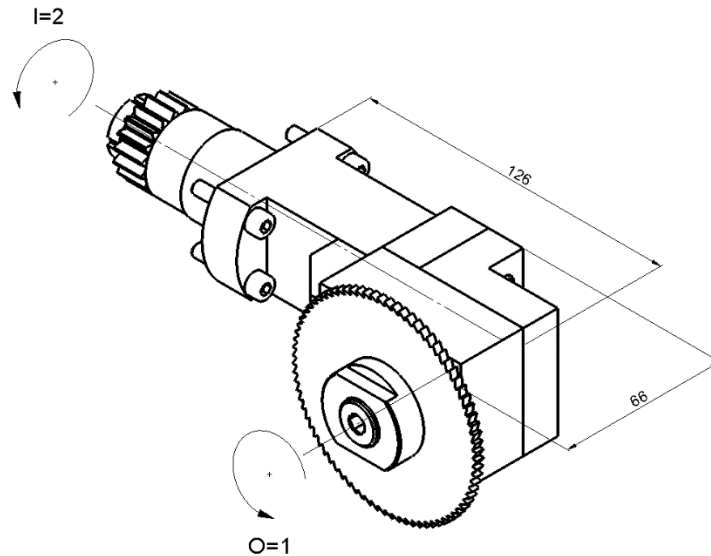
BSS122

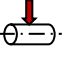
Macchina: CITIZEN Cincom
Tipo: L220X
Posizione, N°: T07 / T08 / T09 / T10
Lavoro al: Mandrino principale e Contromandrino
Tipo di lavoro: 
 n_{max} : 1'000 [rpm]
 $i (n_i / n_o)$: 2 / 1
Ataccamento: Albero \varnothing 22
Senza refrigerante
Informazioni: