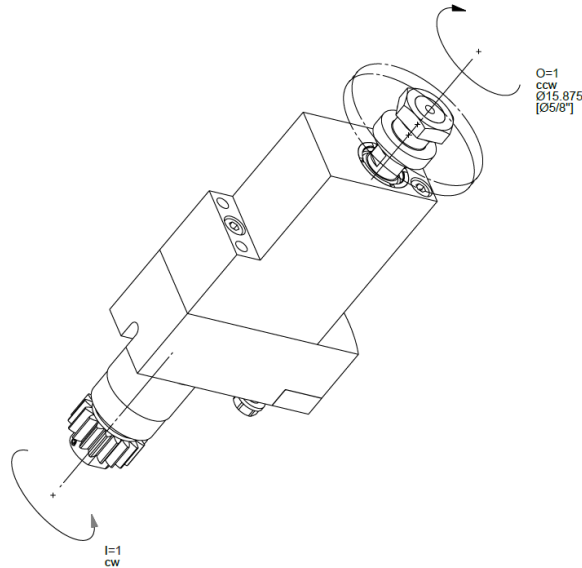
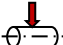
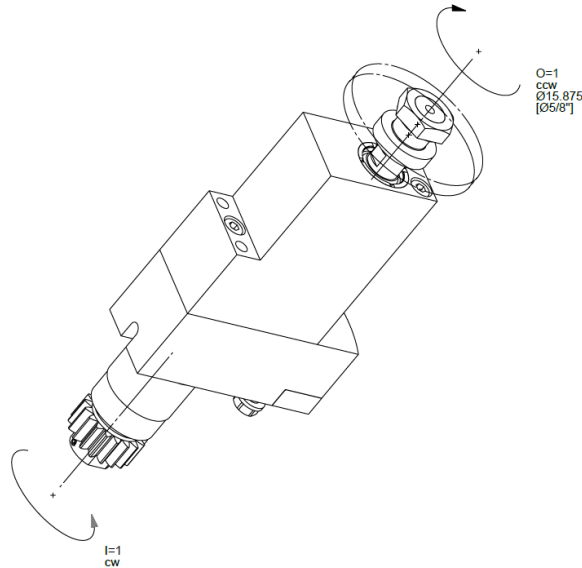
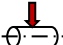

GSS15835-DEC-II

Machine: CITIZEN Cincom
Type: L220/L32
Emplacement, N°: Coulisse linéaire
Travail sur: Broche principale
Type de travail: 
 n_{\max} : 6'000 [rpm]
 $i (n_i / n_o)$: 1 / 1
Attachement: Arbre Ø15.875 mm (Ø5/8")
Sans refroidissement
Infos: Fraise-scie

- Ø 63 mm
- Largeur max. de l'outil : 8 mm

GSS15835-DEC-II

Machine: CITIZEN Cincom
Type: L220/L32
Location, N°: Gangtool
Work on: Main spindle
Type of work: 
 n_{max} : 6'000 [rpm]
 $i (n_i / n_o)$: 1 / 1
Attachement: Shaft Ø15.875 mm (Ø5/8")

Without coolant

Infos: Slitting saw

- Ø 63 mm
- Max tool width: 8 mm

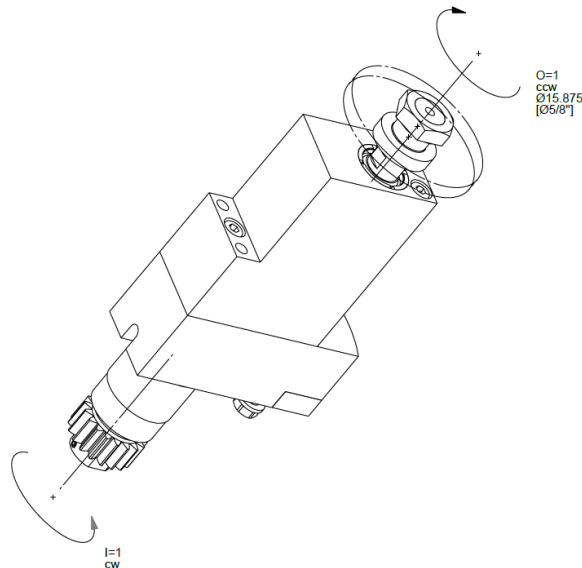
GSS15835-DEC-II

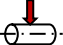
Maschine: CITIZEN Cincom
Typ: L220/L32
Position, N°: Vertikalhalter
Arbeit über: Hauptspindel
Arbeitstyp: 
 n_{max} : 6'000 [rpm]
 $i (n_i / n_o)$: 1 / 1
Befestigung: Welle Ø15.875 mm (Ø5/8")

Ohne Kühlmittel

Infos: Frässağeblätter

- Ø 63 mm
- Max Werkzeugbreite: 8 mm

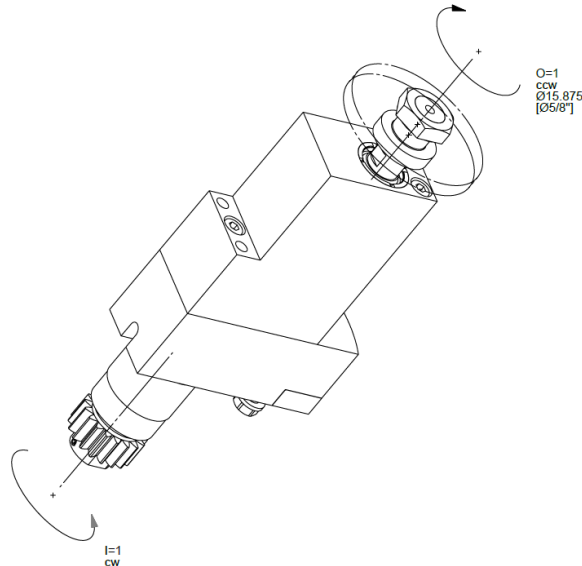
GSS15835-DEC-II

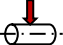
Macchina: CITIZEN Cincom
Tipo: L220/L32
Posizione, N°: Slitta lineare
Lavoro al: Mandrino principale
Tipo di lavoro: 
 n_{max} : 6'000 [rpm]
 $i (n_i / n_o)$: 1 / 1
Ataccamento: Albero Ø15.875 mm (Ø5/8")

Senza refrigerante

Informazioni:

- Ø 63 mm
- Max larghezza: 8 mm