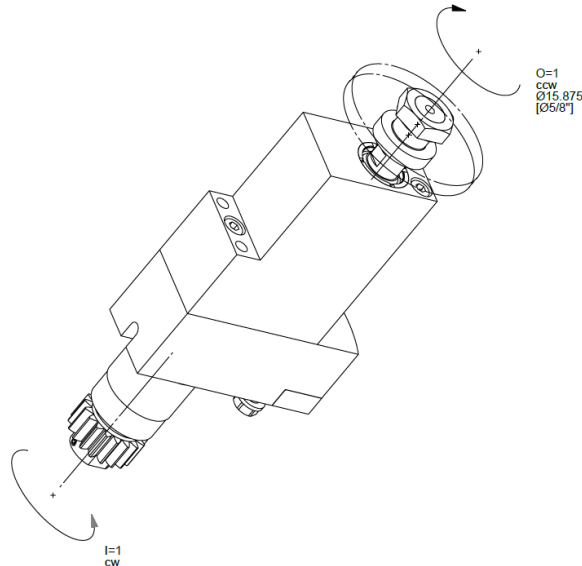

GSS15835-DEC

Machine: CITIZEN Cincom

Type: A32

Emplacement, N°: Coulisse linéaire

Travail sur: Broche principale

Type de travail:  n_{\max} : 6'000 [rpm] $i (n_i / n_o)$: 1 / 1

Attachement: Arbre Ø15.875 mm (Ø5/8")

Sans refroidissement

Infos: Fraise-scie

- Ø 63 mm
- Largeur max. de l'outil : 8 mm

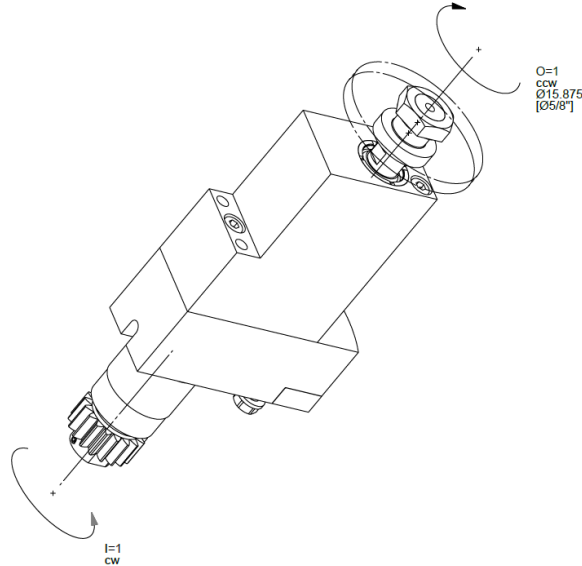
GSS15835-DEC

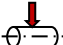
Machine: CITIZEN Cincom
Type: A32
Location, N°: Gangtool
Work on: Main spindle
Type of work: 
 n_{max} : 6'000 [rpm]
 $i (n_i / n_o)$: 1 / 1
Attachement: Shaft Ø15.875 mm (Ø5/8")

Without coolant

Infos: Slitting saw

- Ø 63 mm
- Max tool width: 8 mm

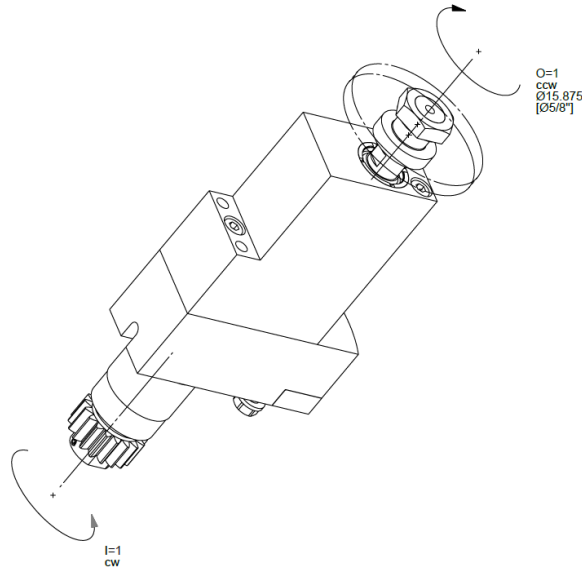
GSS15835-DEC

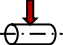
Maschine: CITIZEN Cincom
Typ: A32
Position, N°: Vertikalhalter
Arbeit über: Hauptspindel
Arbeitstyp: 
 n_{max} : 6'000 [rpm]
 $i (n_i / n_o)$: 1 / 1
Befestigung: Welle Ø15.875 mm (Ø5/8")

Ohne Kühlmittel

Infos: Frässağeblätter

- Ø 63 mm
- Max Werkzeugbreite: 8 mm

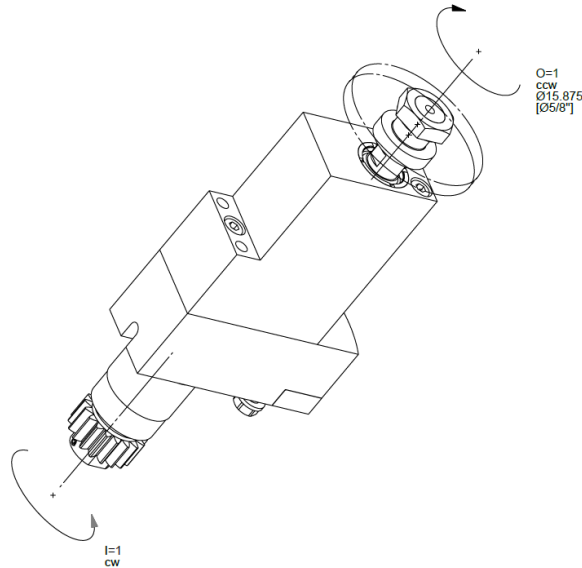
GSS15835-DEC

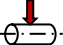
Macchina: CITIZEN Cincom
Tipo: A32
Posizione, N°: Slitta lineare
Lavoro al: Mandrino principale
Tipo di lavoro: 
 n_{max} : 6'000 [rpm]
 $i (n_i / n_o)$: 1 / 1
Ataccamento: Albero Ø15.875 mm (Ø5/8")
Senza refrigerante

Informazioni:

- Ø 63 mm
- Max larghezza: 8 mm