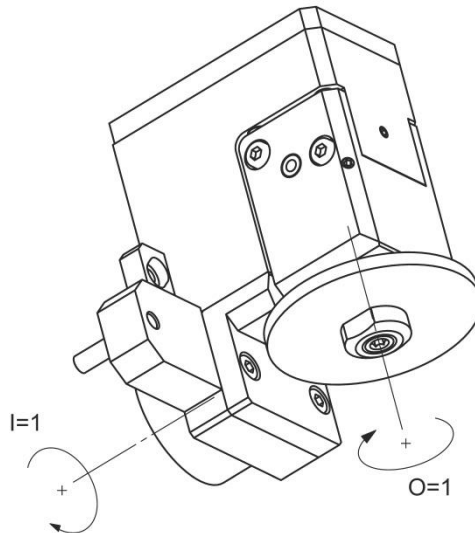
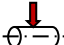

P03-GSP-318

Machine: TSUGAMI
Type: P03
Emplacement, N°: Coulisse linéaire
Travail sur: Broche principale
Type de travail: 
 n_{max} : 8'000 [rpm]
 $i (n_i / n_o)$: 1 / 1
Attachement: Arbre Ø 8

Sans refroidissement

Infos:

- Polygoneur pour bloc P03-GSC-117-S
- Fraise disque utilisée, $\varnothing_{max}=45mm$, Largeur $L=3mm$
- Ligne de coupe alignée aux burins du bloc P03-GSC-117-S
- Inclinaison de la tête : $0...1.5^\circ$

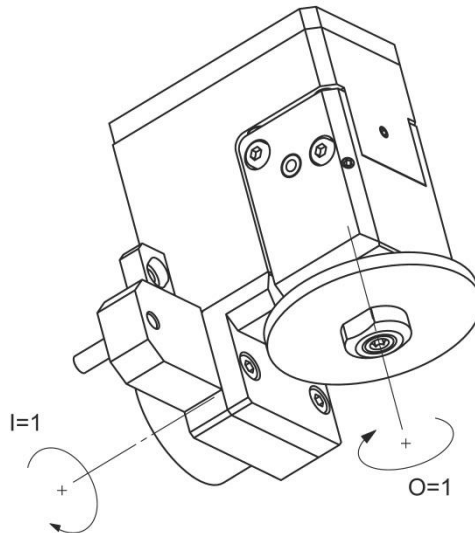
P03-GSP-318

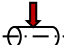
Machine: TSUGAMI
Type: P03
Location, N°: Gangtool
Work on: Main spindle
Type of work: 
 n_{max} : 8'000 [rpm]
 $i (n_i / n_o)$: 1 / 1
Attachement: Arbor \varnothing 8

Without coolant

Infos:

- Driven toolholder for polygon milling on the support P03-GSC-117-S
- Milling cutters, $\varnothing_{max}=45\text{mm}$, Width $L=3\text{mm}$
- Line of cutting aligned in the chisels of the support P03-GSC-117-S
- Slope $0 \dots 1.5^\circ$

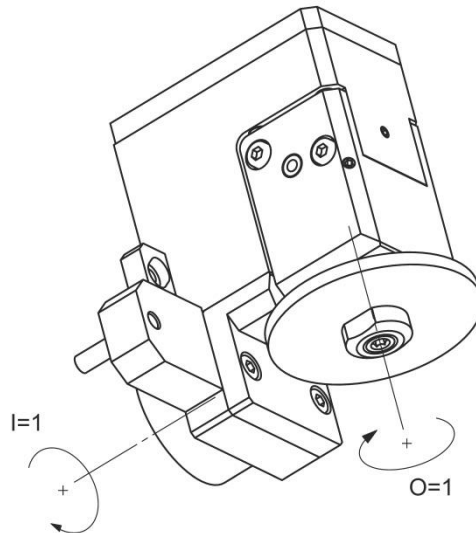
P03-GSP-318

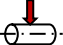
Maschine: TSUGAMI
Typ: P03
Position, N°: Vertikalhalter
Arbeit über: Hauptspindel
Arbeitstyp: 
 n_{\max} : 8'000 [rpm]
 i (n_i / n_o): 1 / 1
Befestigung: Welle \varnothing 8

Ohne Kühlmittel

Infos:

- Angetriebener Fräserhalter für Polygonfräser für P03-GSC-117-S
- Polygonfräser, $\varnothing_{\max}=45\text{mm}$, Breite $L=3\text{mm}$
- Schnittlinie zu den p03 Träger Meißel ausgerichtet
- Neigungswinkel $0\dots 1.5^\circ$

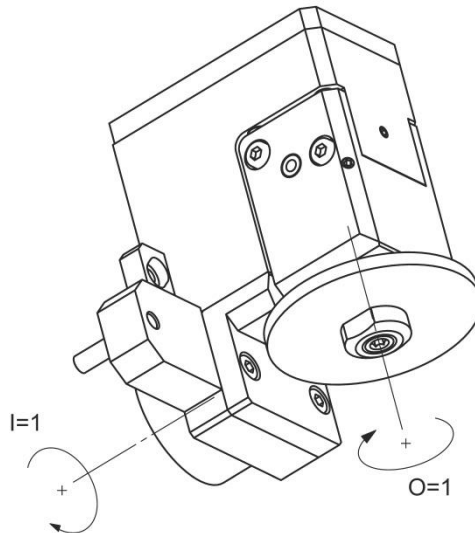
P03-GSP-318

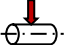
Macchina: TSUGAMI
Tipo: P03
Posizione, N°: Slitta lineare
Lavoro al: Mandrino principale
Tipo di lavoro: 
 n_{max} : 8'000 [rpm]
 i (n_i / n_o): 1 / 1
Ataccamento: Albero \varnothing 8

Senza refrigerante

Informazioni:

- Porta-utensile per poligono fresatura sul supporto P03-GSC-117-S
- Poligono fresatura, $\varnothing_{max}=45mm$, Larghezza $L=3mm$
- Linea di taglio allineato ai bulini del supporto P03-GSC-117-S
- Inclinazione $0...1.5^\circ$