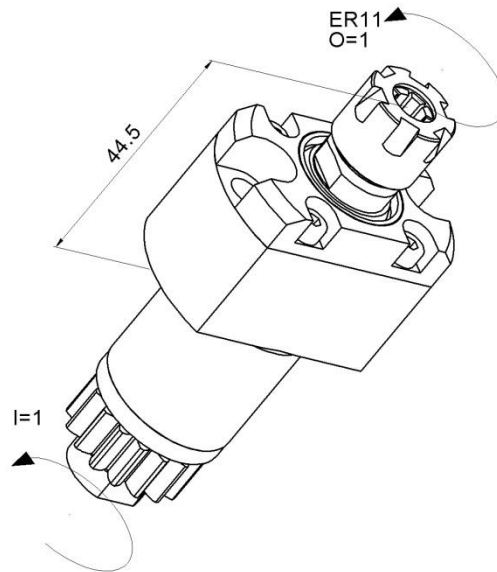
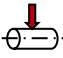
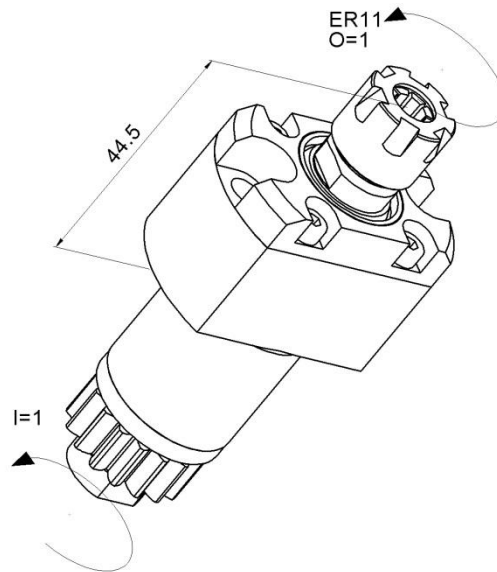
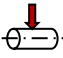
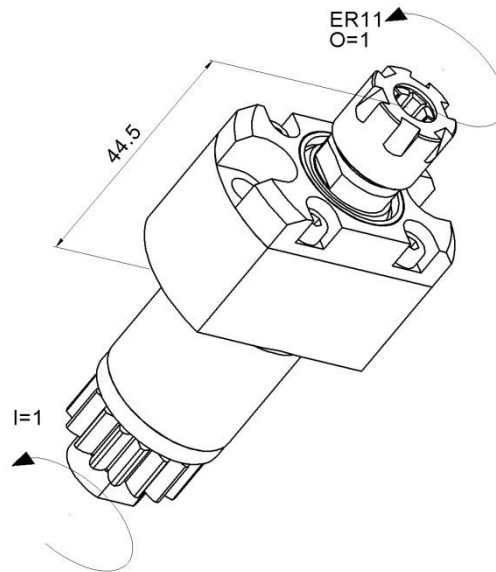

GSC-807

Machine: CITIZEN Cincom
Type: K16E
Emplacement, N°: Coulisse linéaire, T11 à T174
Travail sur: Broche principale / Broche de reprise
Type de travail: 
 n_{max} : 6'000 [rpm]
 $i (n_i / n_o)$: 1 / 1
Attachement: ER 11
Sans refroidissement
Infos:

GSC-807

Machine: CITIZEN Cincom
Type: K16
Location, N°: Gangtool, T11 / T14
Work on: Main spindle / Back spindle
Type of work: 
 n_{max} : 6'000 [rpm]
 $i (n_i / n_o)$: 1 / 1
Attachement: ER 11
Without coolant
Infos:

GSC-807

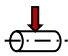
Maschine: CITIZEN Cincom
Typ: K16
Position, N°: Vertikalhalter, T11 / T14
Arbeit über: Hauptspindel / Abgreifspindel
Arbeitstyp: 
 n_{max} : 6'000 [rpm]
 $i (n_i / n_o)$: 1 / 1
Befestigung: ER 11
Ohne Kühlmittel
Infos:

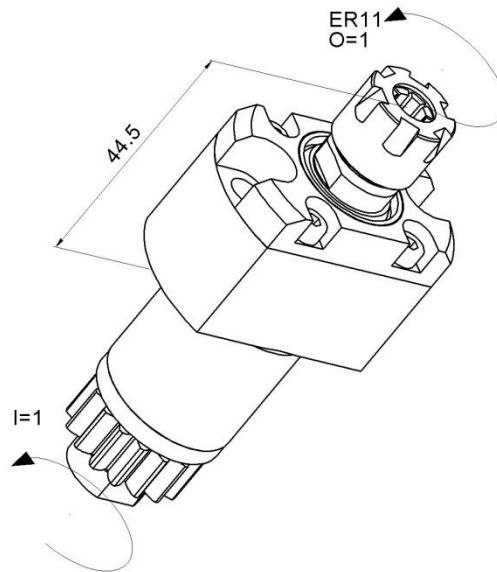
GSC-807

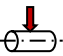
Macchina: CITIZEN Cincom
Tipo: K16
Posizione, N°: Slitta lineare, T11 / T14
Lavoro al: Mandrino principale / Contromandrino
Tipo di lavoro: 
 n_{max} : 6'000 [rpm]
 $i (n_i / n_o)$: 1 / 1
Atacco: ER 11
Senza refrigerante
Informazioni: