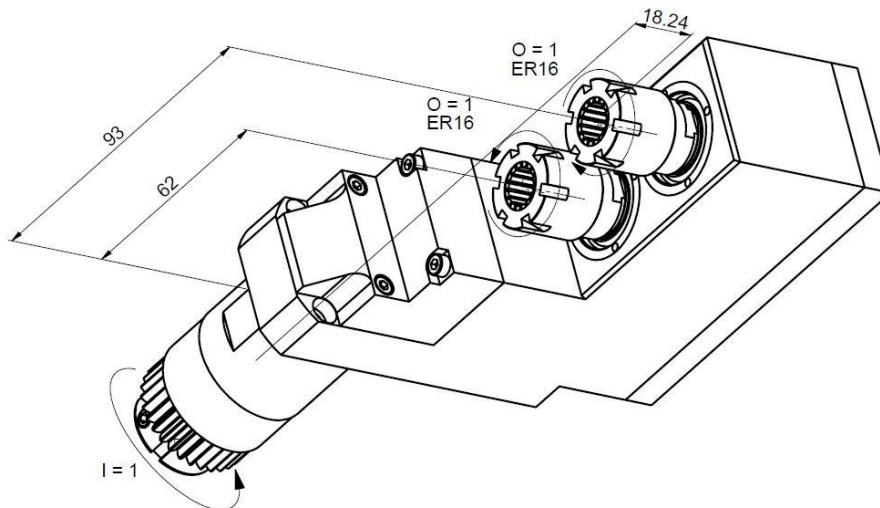

E20-GSE210

Machine: STAR MICRONICS

Type: ECAS 20

SB-12/20R

SR-20RII/III/IV

SR-20J/JN

Emplacement, N°: Bloc linéaire

Travail sur: Broche principale

Type de travail: n_{max}: 8000 [rpm]i (n_i / n_o): 1 / 1

Attachement: 2x ER16

Infos:

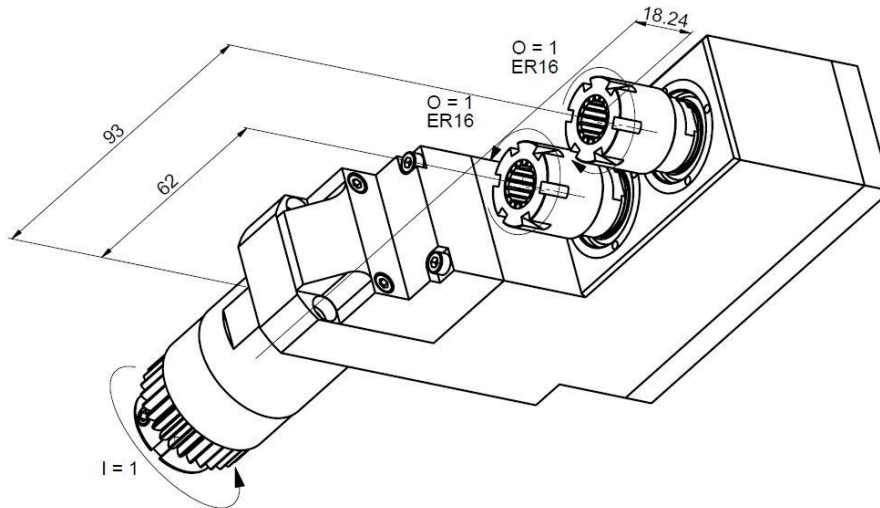
E20-GSE210

Machine: STAR MICRONICS

Type: ECAS 20

SB-12/20R

SR-20RII/III/IV

SR-20J/JN

Location, N°: Gangtool

Work on: Main spindle

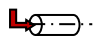
Type of work: n_{max}: 8000 [rpm]i (n_i / n_o): 1 / 1

Attachement: 2x ER16

Infos:

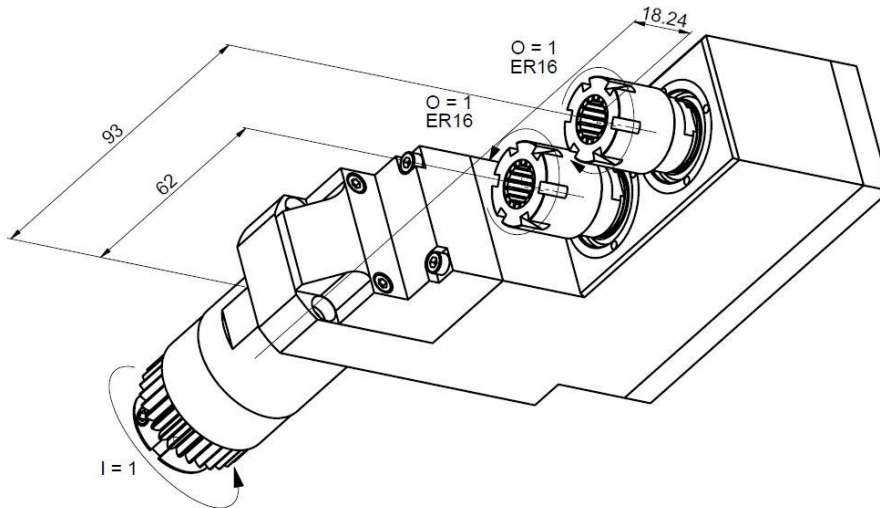
E20-GSE210

Machine: STAR MICRONICS

Typ: ECAS 20

SB-12/20R

SR-20RII/III/IV

SR-20J/JN

Position, N°: Vertikalhalder

Arbeit über: Hauptspindel

Arbeitstyp: n_{max}: 8000 [rpm]i (n_i / n_o): 1 / 1

Befestigung: 2x ER16

Infos:

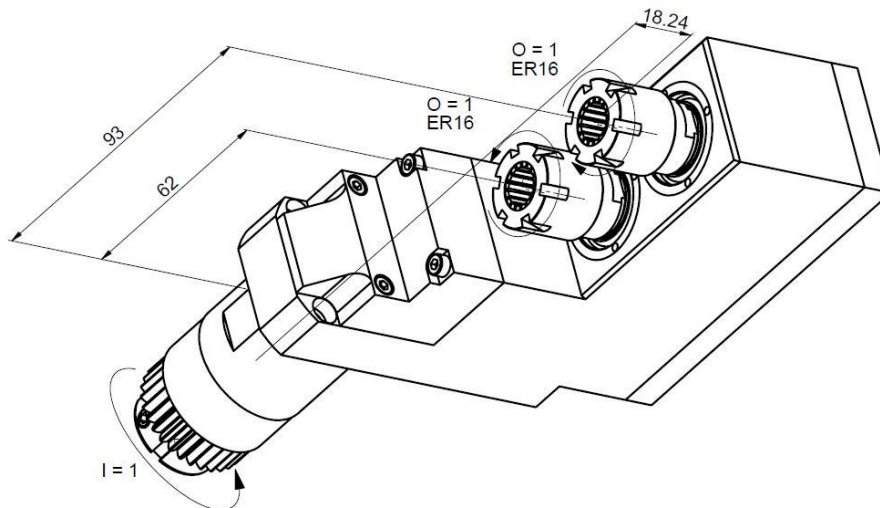
E20-GSE210

Macchina: STAR MICRONICS

Tipo: ECAS 20

SB-12/20R

SR-20RII/III/IV

SR-20J/JN

Posizione, N°: Slitta lineare

Lavoro al: Mandrino principale

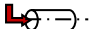
Tipo di lavoro:  n_{max} : 8000 [rpm] i (n_i / n_o): 1 / 1

Ataccamento: 2x ER16

Informazioni: