

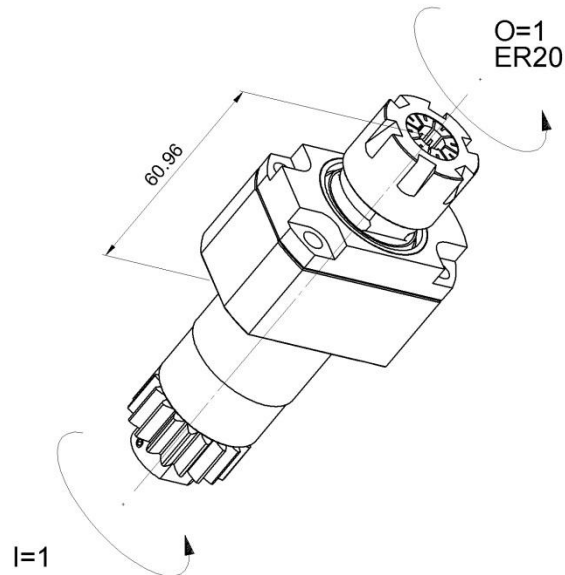
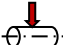
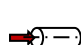
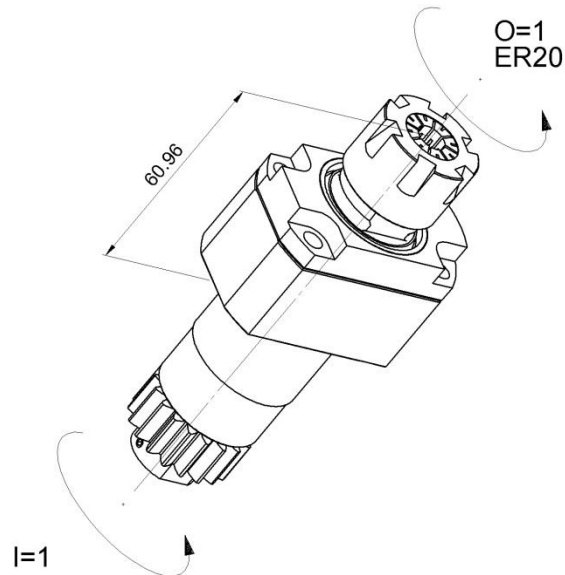
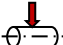
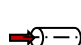
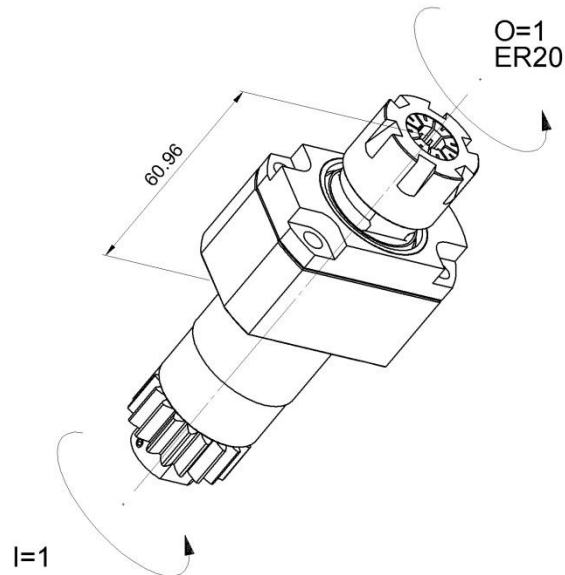

**GSC-1113**

Machine: CITIZEN Cincom  
Type: L32  
Emplacement, N°: Coulisse linéaire  
Travail sur: Broche principale / Broche de reprise  
Type de travail:    
 $n_{max}$ : 6'000 [rpm]  
 $i (n_i / n_o)$ : 1 / 1  
Attachement: ER 20  
Sans refroidissement  
Infos:

**GSC-1113**

Machine: CITIZEN Cincom  
Type: L32  
Location, N°: Gangtool  
Work on: Main spindle / Back spindle  
Type of work:    
 $n_{max}$ : 6'000 [rpm]  
 $i (n_i / n_o)$ : 1 / 1  
Attachement: ER 20  
Without coolant  
Infos:

**GSC-1113**

Maschine: CITIZEN Cincom  
Typ: L32  
Position, N°: Vertikalhalter Arbeit über: Hauptspindel / Abgreifspindel  
Arbeitstyp:   
 $n_{max}$ : 6'000 [rpm]  
 $i (n_i / n_o)$ : 1 / 1  
Befestigung: ER 20  
Ohne Kühlmittel  
Infos:

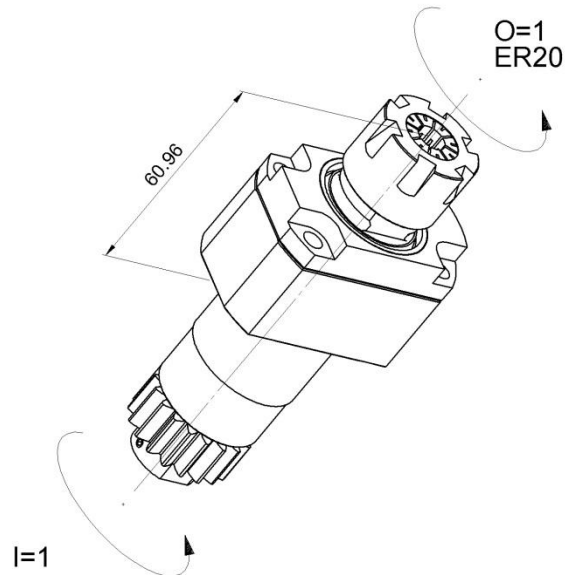
**GSC-1113**

Macchina: CITIZEN Cincom  
Tipo: L32  
Posizione, N°: Slitta lineare  
Lavoro al: Mandrino principale / Contromandrino  
Tipo di lavoro:   
 $n_{max}$ : 6'000 [rpm]  
 $i (n_i / n_o)$ : 1 / 1  
Ataccamento: ER 20  
Senza refrigerante  
Informazioni: