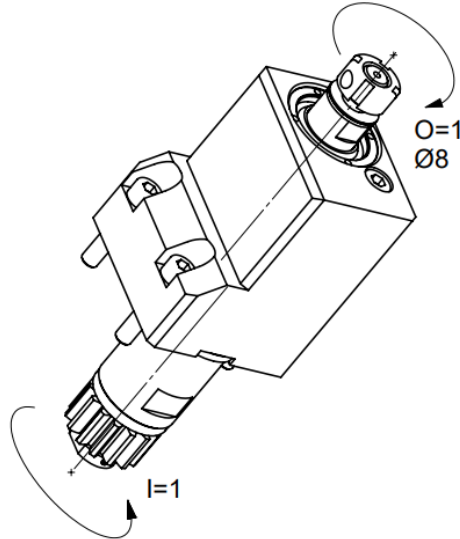

**GSS608**

Machine: CITIZEN Cincom

Type: L12 1M7 / M416

Emplacement, N°: M416 Upper Gang tool post

L112 1M7 Upper Gang tool post

L212 1M7 Upper Gang tool post

Travail sur: Broche principale

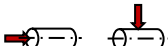
Type de travail: i (n<sub>i</sub> / n<sub>o</sub>): 1 / 1

Attachement: Arbre Ø 8

Sans refroidissement

Infos: Fraise-scie

- Ø = 40mm
- Largeur max = 4.5mm

**GSS608**

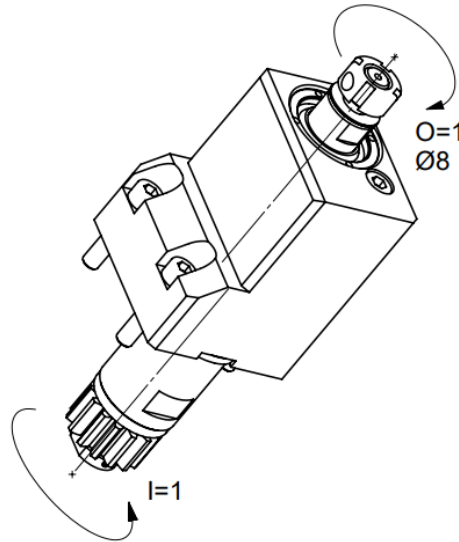

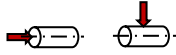

Machine: CITIZEN Cincom  
Type: L12 1M7 / M416  
Location, N°: M416 Upper Gang tool post  
L112 1M7 Upper Gang tool post  
L212 1M7 Upper Gang tool post  
Work on: Main spindle  
Type of work:   
i (n<sub>i</sub> / n<sub>o</sub>): 1 / 1  
Attachement: Shaft Ø 8

Without coolant

Infos: Mill saw

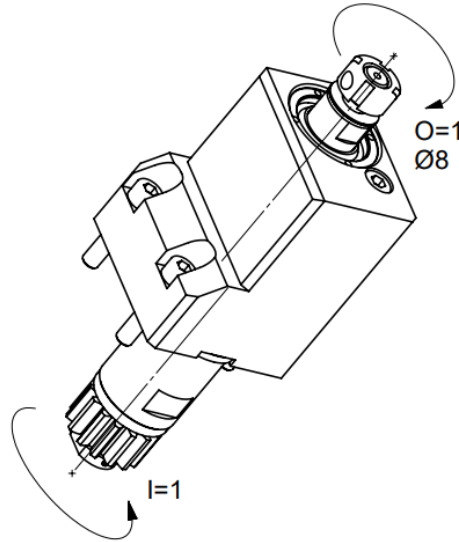
- Use 2 positions
- Ø = 40mm
- Width max = 4.5mm

**GSS608**

Maschine: CITIZEN Cincom  
Typ: L12 1M7 / M416  
Position, N°: M416 Upper Gang tool post  
L112 1M7 Upper Gang tool post  
L212 1M7 Upper Gang tool post  
Arbeit über: Hauptspindel  
Arbeitstyp:   
i (n<sub>i</sub> / n<sub>o</sub>): 1 / 1  
Befestigung: Welle Ø 8

Ohne Kühlmittel

Infos: Frässaßeblätter

- Blockiert 2 Positionen
- Ø = 40mm
- Breite max = 4.5mm

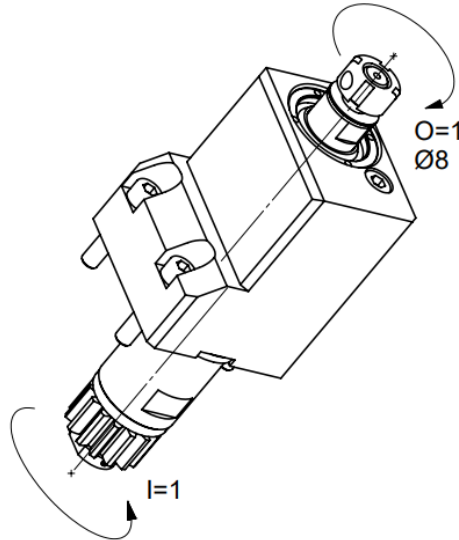
**GSS608**

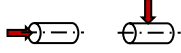
Macchina: CITIZEN Cincom  
Tipo: L12 1M7 / M416  
Posizione, N°: M416 Upper Gang tool post  
L112 1M7 Upper Gang tool post  
L212 1M7 Upper Gang tool post  
Lavoro al: Mandrino principale  
Tipo di lavoro:   
i (n<sub>i</sub> / n<sub>o</sub>): 1 / 1  
Ataccamento: Albero Ø 8

Senza refrigerante

Informazioni:

- Utilizza 2 posizioni
- Ø = 40mm
- Larghezza max =4.5mm