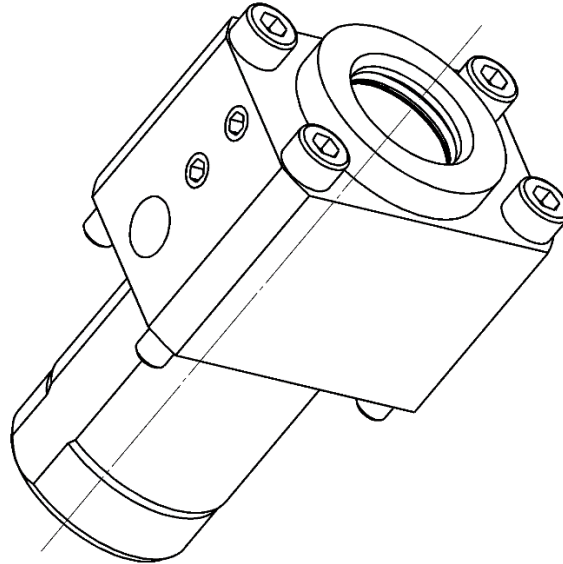

SAU819-IK

Machine: CITIZEN

Type: L32-1M8 / L32-1M9 / L32-1M10 / L32-1M10

Emplacement, N°: Back tool post / Opposite tool post

Travail sur: Broche principale / Broche de reprise

Type de travail: 

Attachement: Ø 19.05 mm

Refroidissement interne Pression maximale : 200 [bar]

Infos:

La conduite haute pression n'est pas livrée.

Taraudage pour conduite haute pression: G1/8.

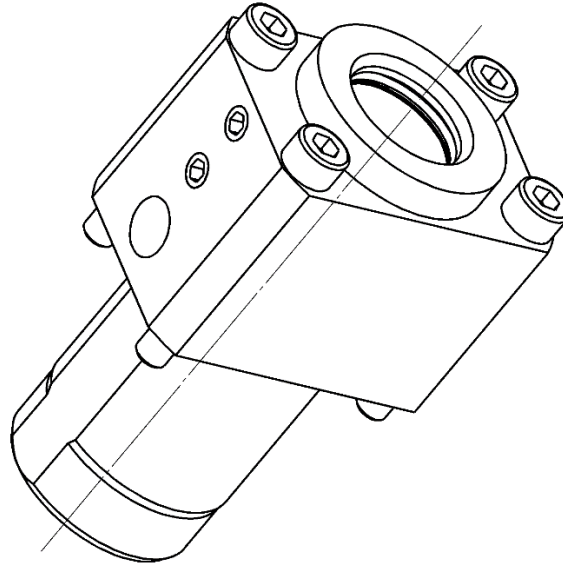
SAU819-IK

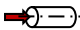
Machine: CITIZEN
Type: L32-1M8 / L32-1M9 / L32-1M10 / L32-1M10
Location, N°: Back tool post / Opposite tool post
Work on: Main spindle / Back spindle
Type of work: 
Attachement: Ø 19.05 mm

Internal coolant Maximum pressure: 200 [bar]

Infos:

The high pressure flexible tube is not delivered.

Tapping for high pressure flexible tube: G1/8.

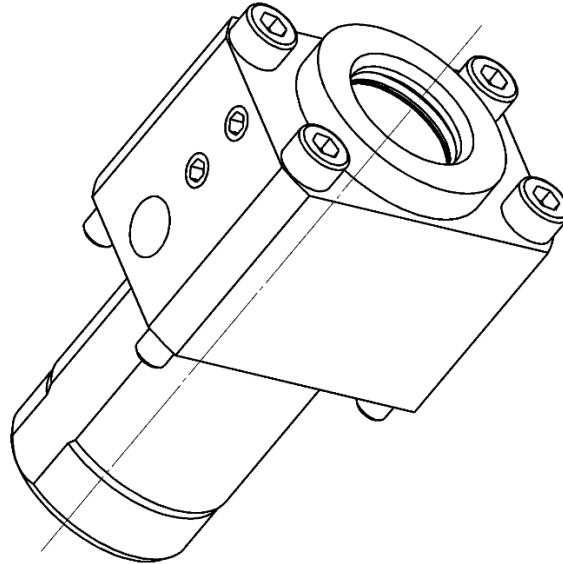
SAU819-IK

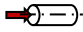
Maschine: CITIZEN
Typ: L32-1M8 / L32-1M9 / L32-1M10 / L32-1M10
Position, N°: Back tool post / Opposite tool post
Arbeit über: Hauptspindel / Abgreifspindel
Arbeitstyp: 
Befestigung: Ø 19.05 mm

Inner Kühlmittel Maximaler Druck: 200 [bar]

Infos:

Die Hochdruckleitung wird nicht geliefert.

Gewindebohrung für Hochdruckleitung: G1/8.