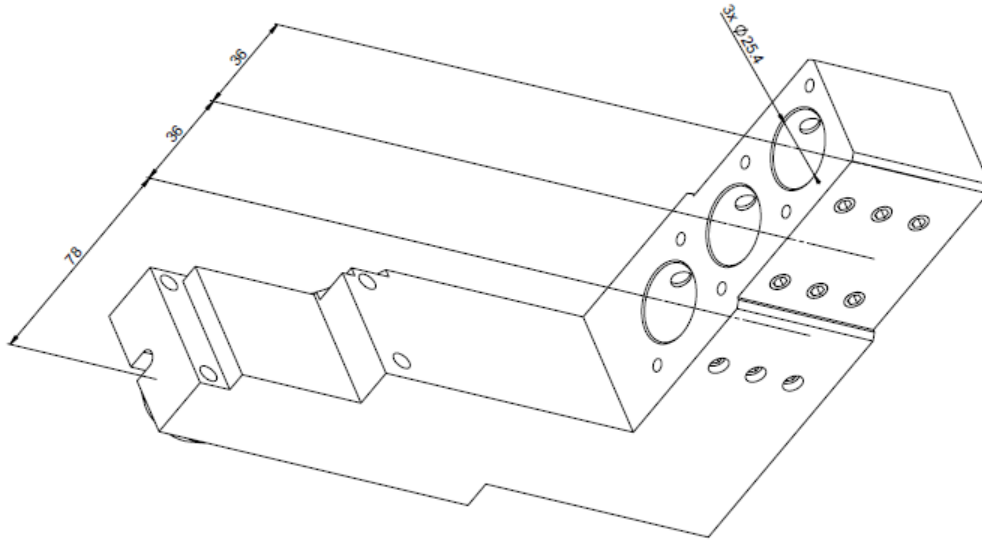

GDF1601-L-I

Machine: CITIZEN

Type: L32-VIII / IX / X / XII

Emplacement, N°: Upper gang tool post

Travail sur: Broche principale

Type de travail: 

Attachement: Ø 25.4 mm

Sans refroidissement

Infos:

Boîtier à 140mm de la broche principale.

Compatible avec les blocs linéaires U30B et U32B.

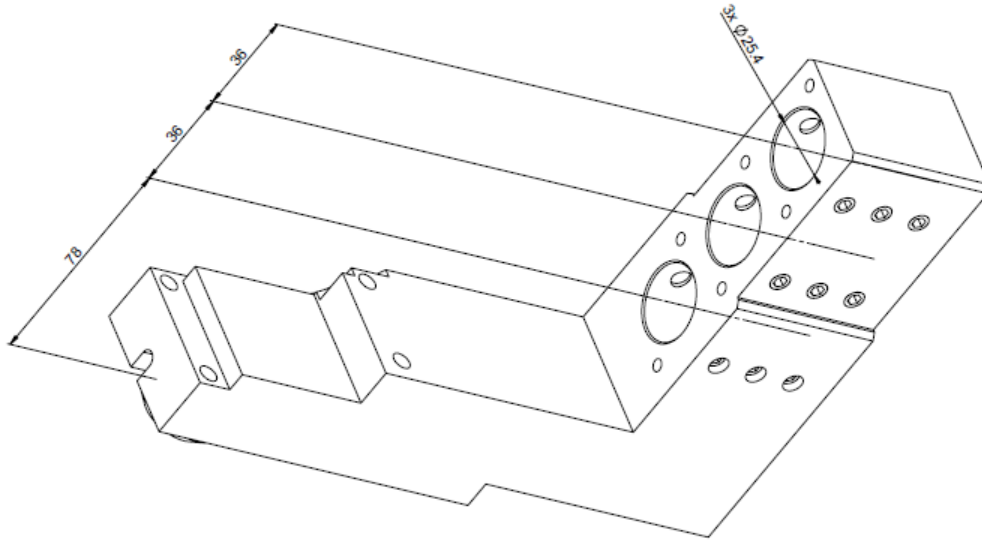
GDF1601-L-I

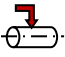
Machine: CITIZEN
Type: L32-VIII / IX / X / XII
Location, N°: Upper gang tool post
Work on: Main spindle
Type of work: 
Attachement: Ø 25.4 mm

Without coolant

Infos:

Housing 140mm from the main spindle.

Compatible with linear blocks U30B and U32B.

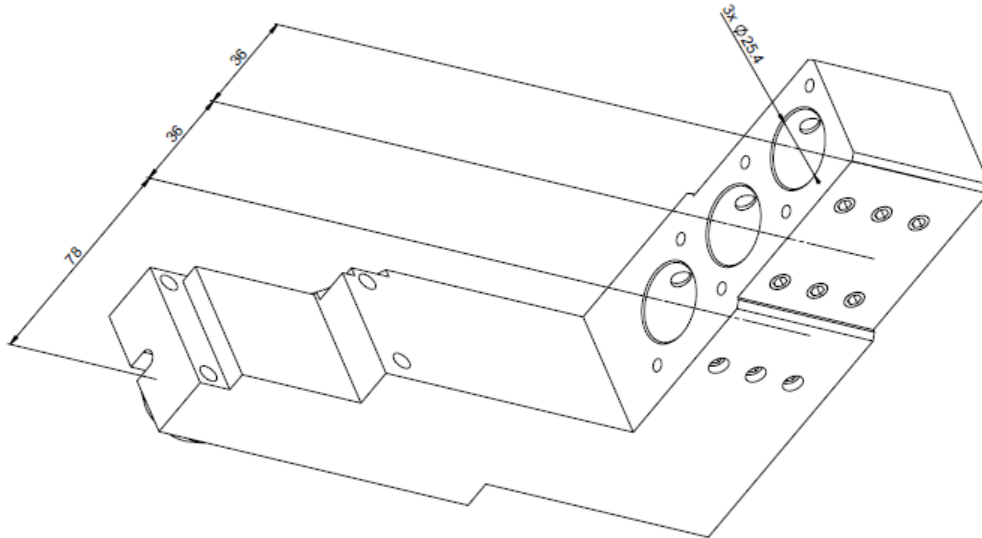
GDF1601-L-I

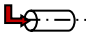
Maschine: CITIZEN
Typ: L32-VIII / IX / X / XII
Position, N°: Upper gang tool post
Arbeit über: Hauptspindel
Arbeitstyp: 
Befestigung: Ø 25.4 mm

Ohne Kühlmittel

Infos:

Gehäuse 140mm von der Hauptspindel entfernt.

Kompatibel mit den Linearblöcken U30B und U32B.