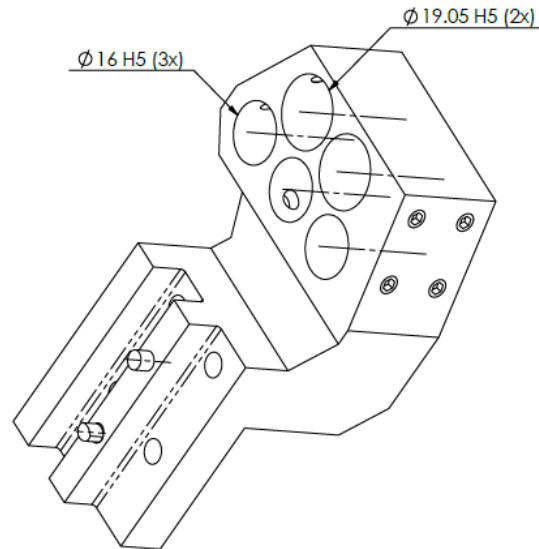

P03-GDF-519

Machine: TSUGAMI

Type: P03

Emplacement, N°: T01+T02 / T13+T14 / T14+T15 / T15+T16 / T16+T17

Travail sur: Broche principale / Broche de reprise

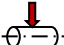
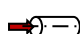
Type de travail:   n_{\max} : - [rpm] i (n_i / n_o): -

Attachement: Autre

Sans refroidissement

Infos:

- Porte-barre d'alésage
- 3xØ16 + 2xØ19.05

P03-GDF-519

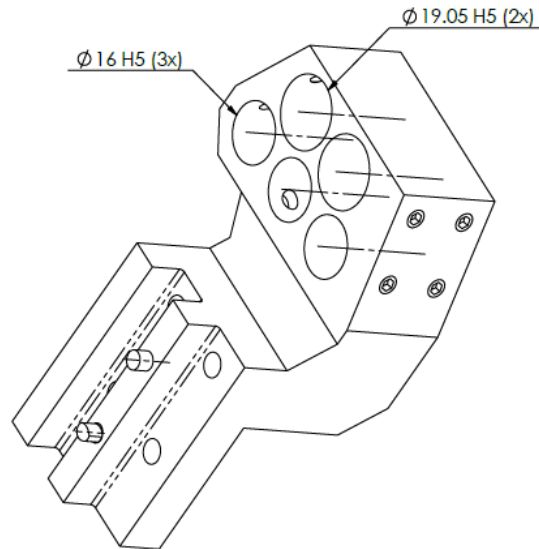

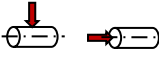
Machine: TSUGAMI
 Type: P03
 Location, N°: T01+T02 / T13+T14 / T14+T15 / T15+T16 / T16+T17
 Work on: Main spindle / Back spindle
 Type of work: 
 n_{max}: - [rpm]
 i (n_i / n_o): 1 / 1
 Attachement: Other
 Without coolan Maximum pressure: _ [bar]

Infos:

- Boring bar holder
- 3xØ16 + 2xØ19.05

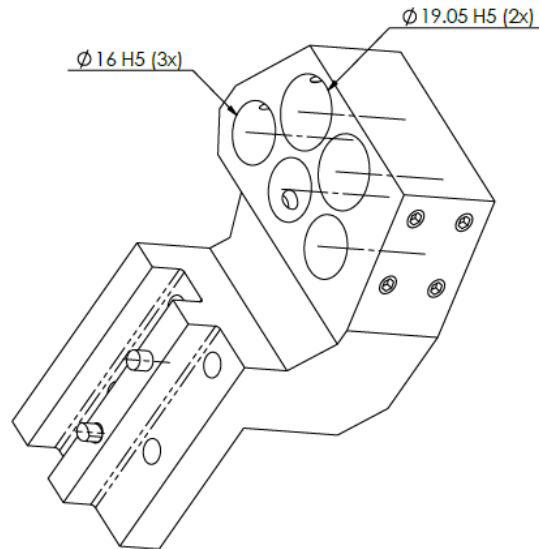
P03-GDF-519

Machine: TSUGAMI

Typ: P03

Position, N°: T01+T02 / T13+T14 / T14+T15 / T15+T16 / T16+T17

Arbeit über: Hauptspindel / Abgreifspindel

Arbeitstyp:  n_{\max} : - [rpm] i (n_i / n_o): -

Befestigung: Andere

Ohne Kühlmittel

Infos:

- Bohrstangenaufnahme
- 3x $\varnothing 16$ + 2x $\varnothing 19.05$

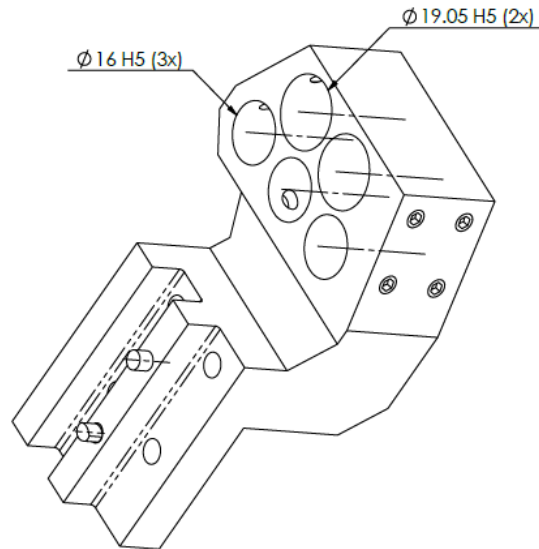
P03-GDF-519

Macchina: TSUGAMI

Tipo: P03

Posizione, N°: T01+T02 / T13+T14 / T14+T15 / T15+T16 / T16+T17

Lavoro al: Mandrino principale / Contromandrino

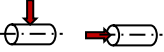
Tipo di lavoro:  n_{max} : - [rpm]i (n_i / n_o): -

Ataccamento: Altro

Senza refrigerante

Informazioni:

- Porta-barra di alesaggio
- $3x\varnothing 16 + 2x\varnothing 19.05$