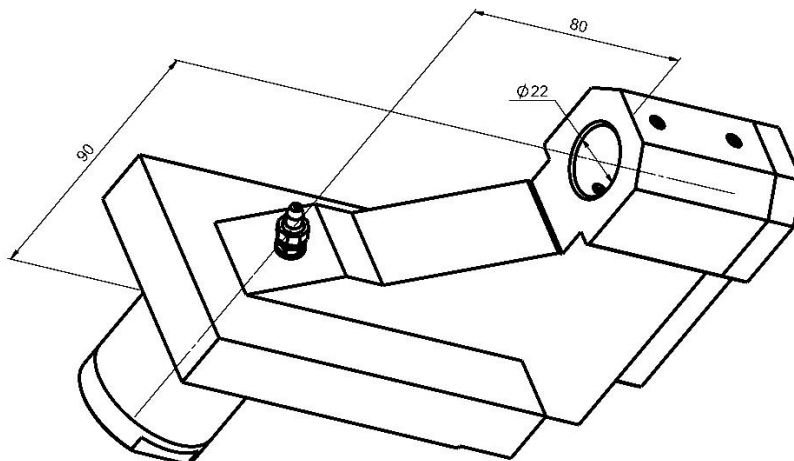

0200-DF220-000H0-1S02

Machine: Star Micronics

Type: ST20/ Ecas20T/ SV20R

Emplacement, N°: Tourelle

Travail sur: Broche principale / Broche de reprise

Type de travail: n_{max}: - [rpm]i (n_i / n_o): - / -

Attachement: Ø 22 mm

Refroidissement externe / Refroidissement interne Pression maximale: 120 [bar]

Infos:

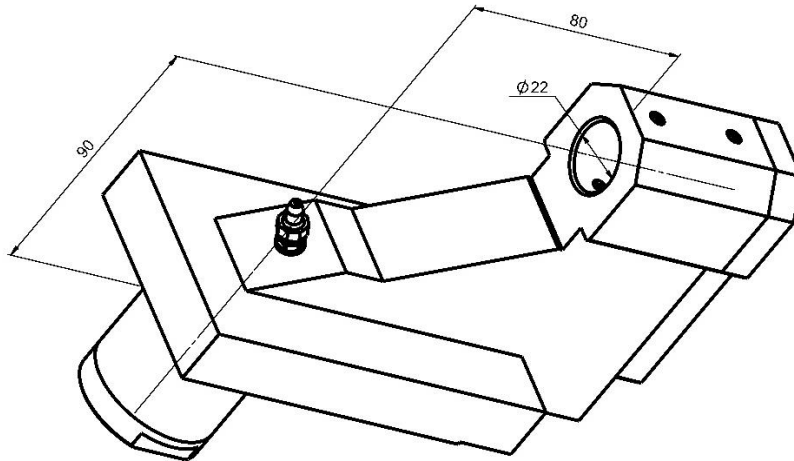
0200-DF220-000H0-1S02

Machine: Star Micronics

Type: ST20/ Ecas20T/ SV20R

Location, N°: Turret

Work on: Main spindle / Back spindle

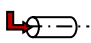
Type of work: n_{max}: - [rpm]i (n_i / n_o): - / -

Attachement: Ø 22 mm

External coolant / Internal coolant Maximum pressure: 120 [bar]

Infos:

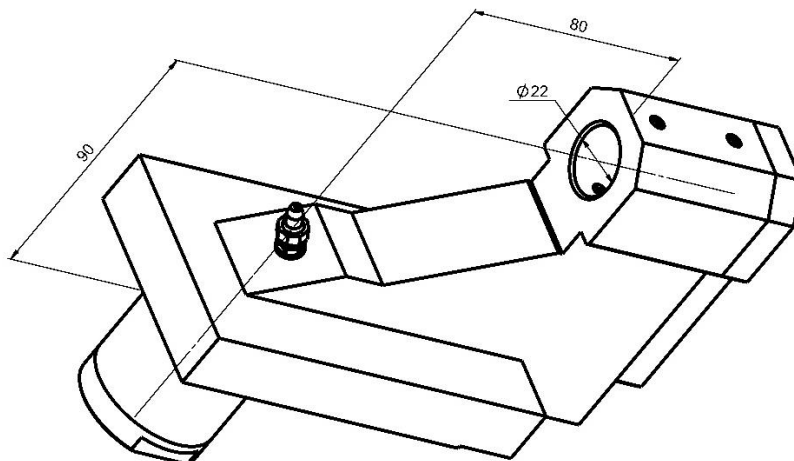
0200-DF220-000H0-1S02

Machine: Star Micronics

Typ: ST20/ Ecas20T/ SV20R

Position, N°: Revolver

Arbeit über: Hauptspindel / Abgreifspindel

Arbeitstyp:

n_{max}: - [rpm]i (n_i / n_o): - / -

Befestigung: Ø 22 mm

Ausser Kühlmittel / Inner Kühlmittel Maximaler Druck:120 [bar]

Infos:

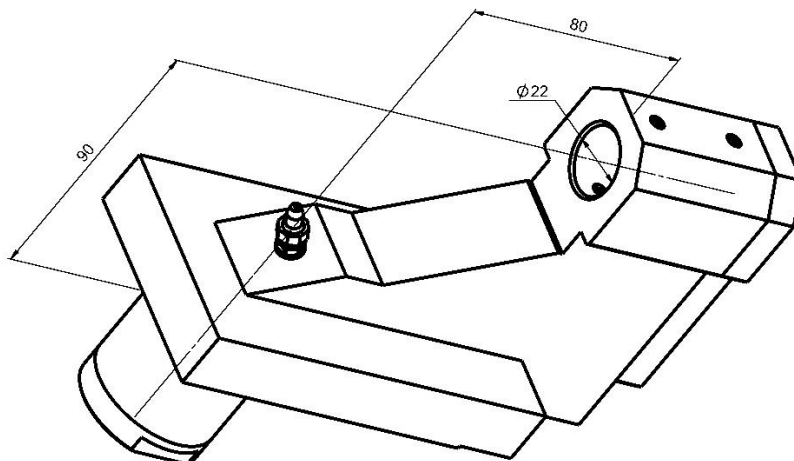
0200-DF220-000H0-1S02

Macchina: Star Micronics

Tipo: ST20/ Ecas20T/ SV20R

Posizione, N°: Toretta

Lavoro al: Mandrino principale / Contromandrino

Tipo di lavoro:  n_{max} : - [rpm]i (n_i / n_o): - / -Atacco: ϕ 22 mm

Refrigerante esterno / Refrigerante interno Pressione massima: 120 [bar]

Informazioni: