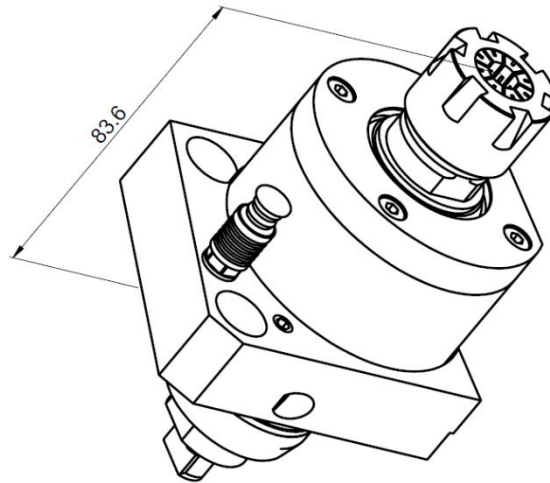

KSC113-ER-IK

Machine: CITIZEN

Type: M32-5M3 / M32-5M5 / M32-5M7 / M32-5M8

Emplacement, N°: Turret

Travail sur: Broche principale / Broche de reprise

Type de travail: i (n_i / n_o): 1 / 1

Attachement: ER 20

Refroidissement interne Pression maximale : 200 [bar]

Infos:

Le liquide de refroidissement peut être couplé à un porte-outil pour le travail sur la broche de reprise.

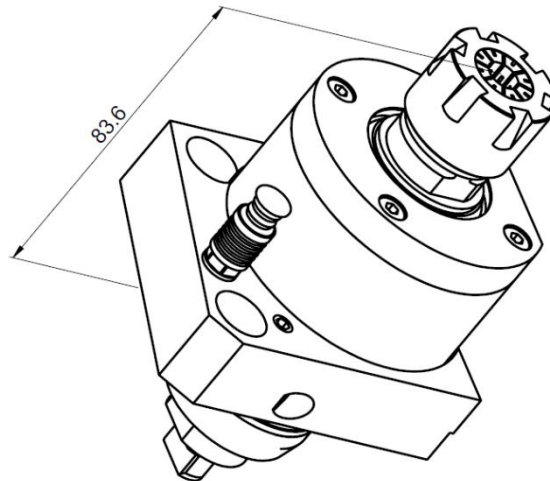
KSC113-ER-IK

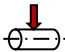
Machine: CITIZEN
Type: M32-5M3 / M32-5M5 / M32-5M7 / M32-5M8
Location, N°: Turret
Work on: Main spindle / Back spindle
Type of work: 
i (n_i / n_o): 1 / 1
Attachement: ER20

Internal coolant Maximum pressure: 200 [bar]

Infos:

The coolant can be coupled with a back machining tool holder.

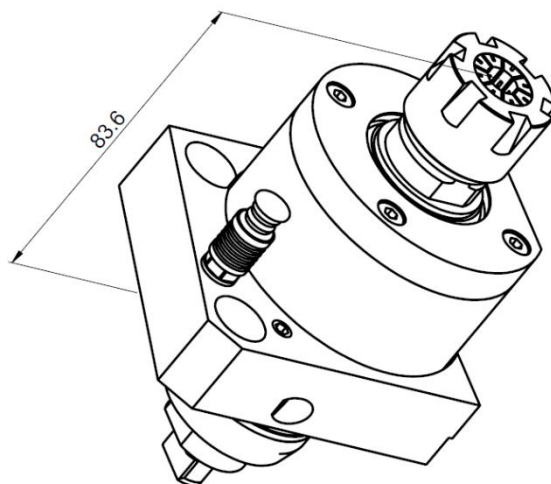
KSC113-ER-IK

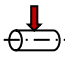
Maschine: CITIZEN
Typ: M32-5M3 / M32-5M5 / M32-5M7 / M32-5M8
Position, N°: Turret
Arbeit über: Hauptspindel / Abgreifspindel
Arbeitstyp: 
i (n_i / n_o): 1 / 1
Befestigung: ER20

Inner Kühlmittel Maximaler Druck: 200 [bar]

Infos:

Die Kühlmittel kann mit einem Werkzeughalter für die Arbeit an der Abgreifspindel gekoppelt werden.