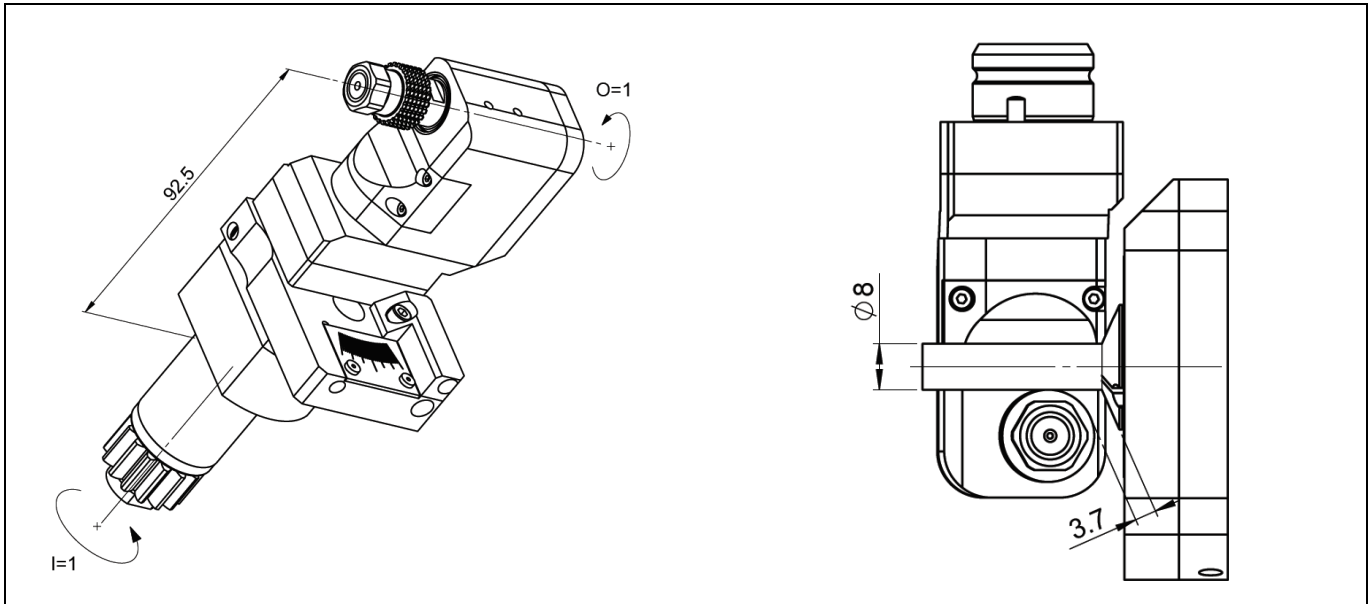

**CITIZEN5-LSH-080**

Machine: CITIZEN

Type: L12-VII

Emplacement, N°: Coulisse linéaire – T10

Travail sur: Broche principale

Type de travail: n<sub>max</sub>: 10'000 [rpm]i (n<sub>i</sub> / n<sub>o</sub>): 1 / 1

Attachement: Arbre Ø8mm

Sans refroidissement

Infos:

- Fraise Ømax 18mm
- Largeur de fraise : 5...12 mm
- Inclinaison max. 2°

## CITIZEN5-LSH-080

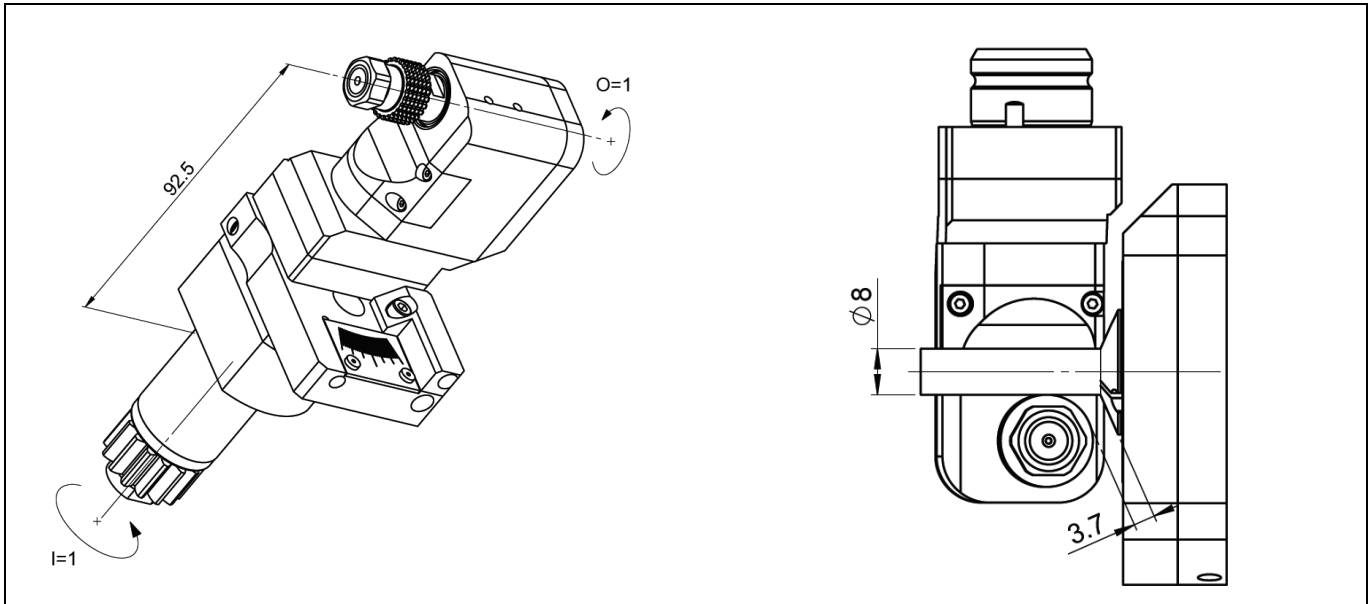

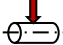
Machine: CITIZEN  
 Type: L12-VII  
 Location, N°: Gangtool – T10  
 Work on: Main spindle  
 Type of work:   
 $n_{max}$ : 10'000 [rpm]  
 $i (n_i / n_o)$ : 1 / 1  
 Attachement: Shaft Ø8mm

Without coolant

Infos:

- Mill Ømax 18mm
- Width of mill cutter : 5...12 mm
- Slope max. 2°

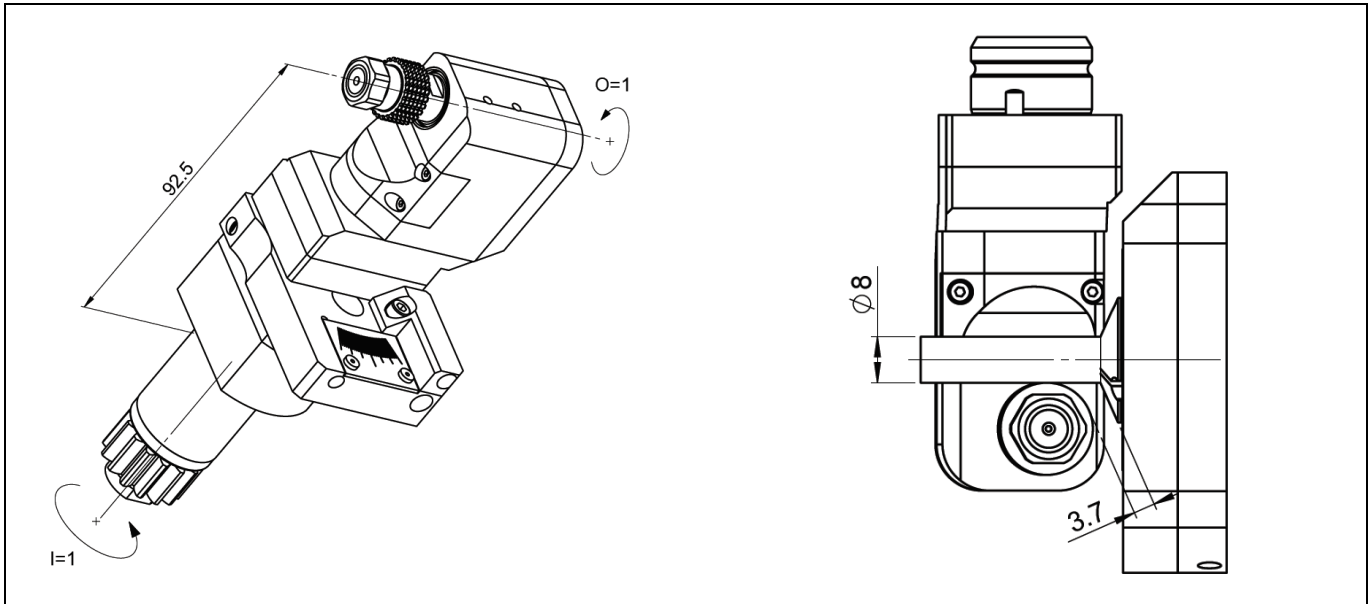
**CITIZEN5-LSH-080**

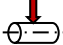
Maschine: CITIZEN  
Typ: L12-VII  
Position, N°: Vertikalhalter – T10  
Arbeit über: Hauptspindel  
Arbeitstyp:   
 $n_{max}$ : 10'000 [rpm]  
 $i$  ( $n_i / n_o$ ): 1 / 1  
Befestigung: Achse Ø8mm

Ohne Kühlmittel

Infos:

- Fräser Ømax 18mm
- Breite von Fräser: 5...12 mm
- Neigungswinkel Max. 2 °

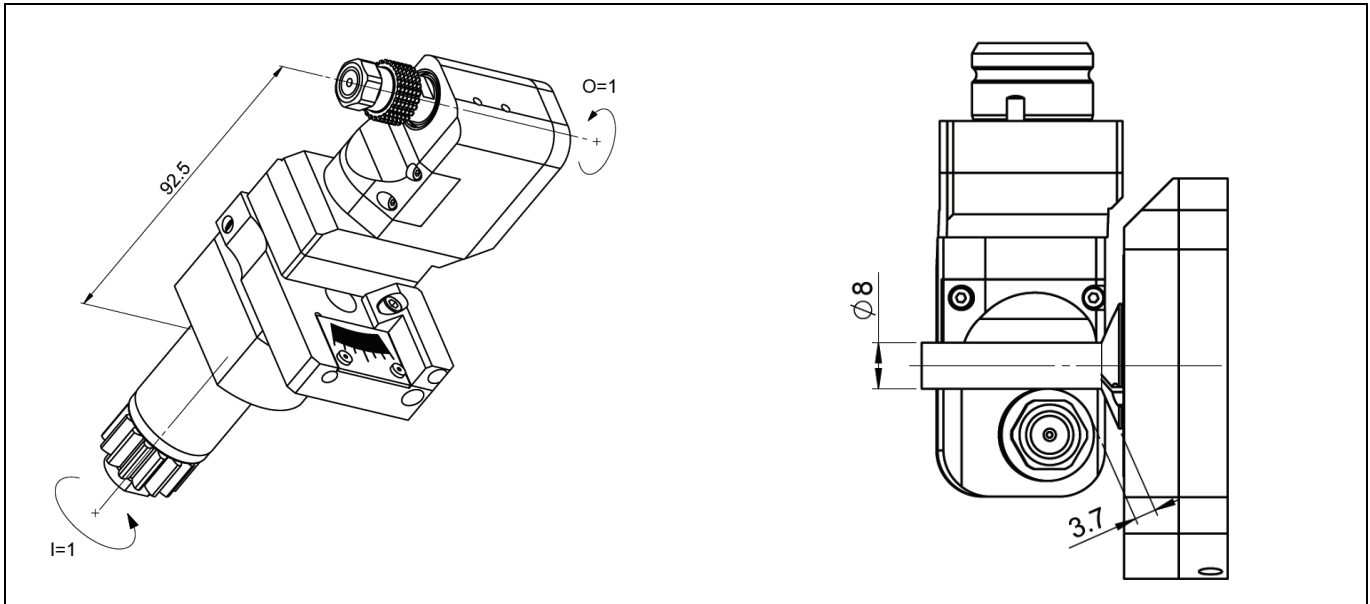
**CITIZEN5-LSH-080**

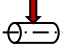
Macchina: CITIZEN  
Tipo: L12-VII  
Posizione, N°: Slitta lineare – T10  
Lavoro al: Mandrino principale  
Tipo di lavoro:   
 $n_{max}$ : 10'000 [rpm]  
 $i (n_i / n_o)$ : 1 / 1  
Ataccamento: Codolo Ø8mm

Senza refrigerante

Informazioni:

- Frese  $\varnothing_{max}$  18mm
- Larghezza di frese : 5...12 mm
- Inclinazione max. 2°