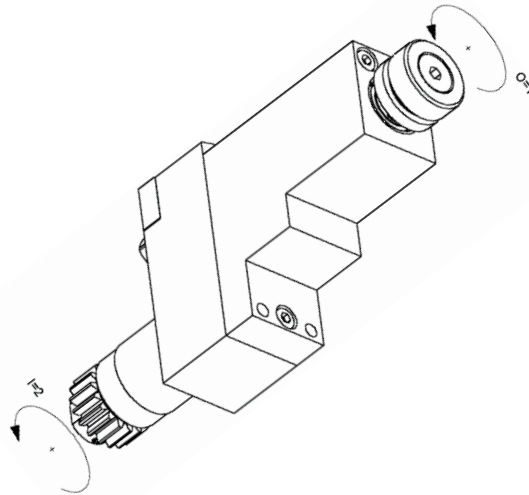
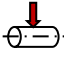
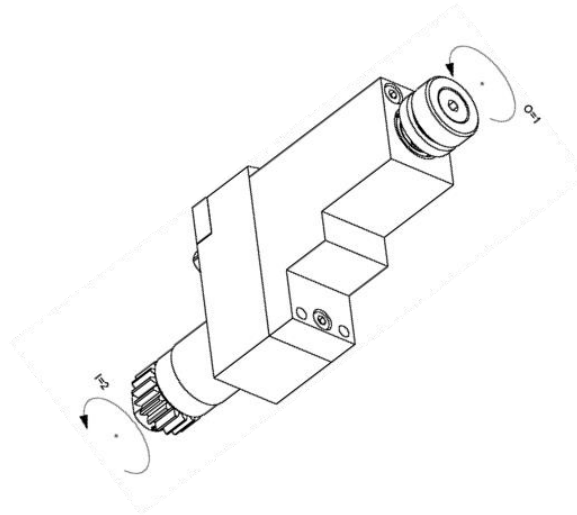
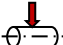
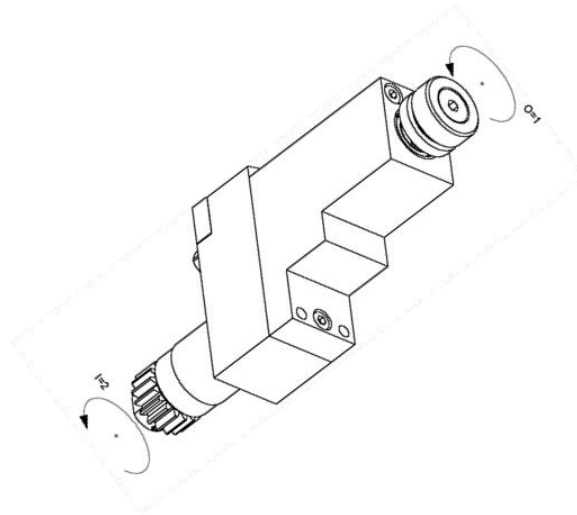

**GSS1035-DEC**

Machine: CITIZEN Cincom  
Type: D25-VIII  
Emplacement, N°: T20-T23, T40, T41  
Travail sur: Broche principale  
Type de travail:   
 $n_{max}$ : 4500 [rpm]  
 $i$  ( $n_i / n_o$ ): 2 / 1  
Attachement: Arbre Ø 22  
Sans refroidissement  
Infos: Fraise-scie Ø80-100

**GSS1035-DEC**

Machine: CITIZEN Cincom  
Type: D25-VIII  
Location, N°: T20-T23, T40, T41  
Work on: Main spindle  
Type of work:   
 $n_{max}$ : 4500 [rpm]  
 $i$  ( $n_i / n_o$ ): 2 / 1  
Attachement: Arbor  $\varnothing$  22  
Without coolant  
Infos: Saw :  $\varnothing$ 80-100

**GSS1035-DEC**

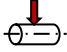
Maschine: CITIZEN Cincom  
Typ: D25-VIII  
Position, N°: T20-T23, T40, T41  
Arbeit über: Hauptspindel  
Arbeitstyp:   
 $n_{max}$ : 4500 [rpm]  
 $i$  ( $n_i / n_o$ ): 2 / 1  
Befestigung: Welle Ø 22  
Ohne Kühlmittel  
Infos: Fräse : Ø80-100

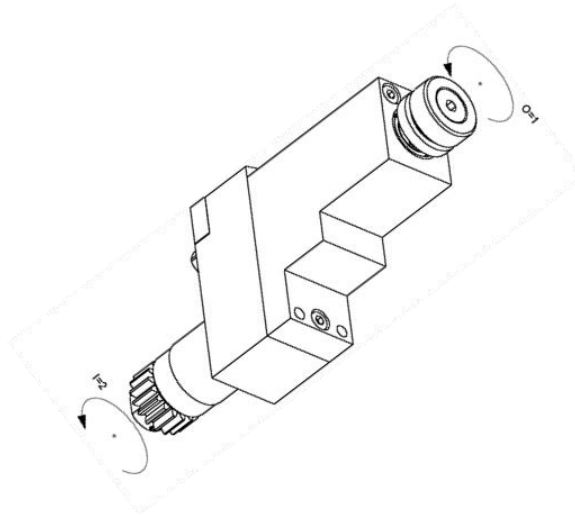
**GSS1035-DEC**

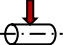
Macchina: CITIZEN Cincom  
Tipo: D25-VIII  
Posizione, N°: T20-T23, T40, T41  
Lavoro al: Mandrino principale  
Tipo di lavoro:   
 $n_{max}$ : 4500 [rpm]  
 $i$  ( $n_i / n_o$ ): 2 / 1  
Ataccamento: Albero Ø 22  
Senza refrigerante  
Informazioni: Sega per fresatura : Ø80-100