

**HOBGING TOOL HOLDER**  
 ATTACHMENT : Ø 3.5mm  
 i (n1:n2) : 1 : 1  
 DEGREE OF INCLINATION : ±2.5°  
 POSITION : FRONT GANG TOOL POST  
 COOLANT : No  
 MACHINE TYPES : CITIZEN R04-5F6-CH

**COMMENTS :**  
 Belt drive: low backlash.  
 Diameter of the mill : Ø 6mm  
 Width of mill cutter : 4-6mm

This tool holder can only be used with the U36J drive unit.

**INCLUDED :**  
 Nut with Ø5.5 bearing face and Washers : 1x 876-994-12  
 Fastening screw : 2x D912 5x12  
 Protection plate : 1x 862-013-055-05 + 2x D912 3x05

**OPTIONS :**  
 Nut with Ø4.5 bearing face : 864-463-08  
 Nut with Ø7 bearing face : 832-052-93

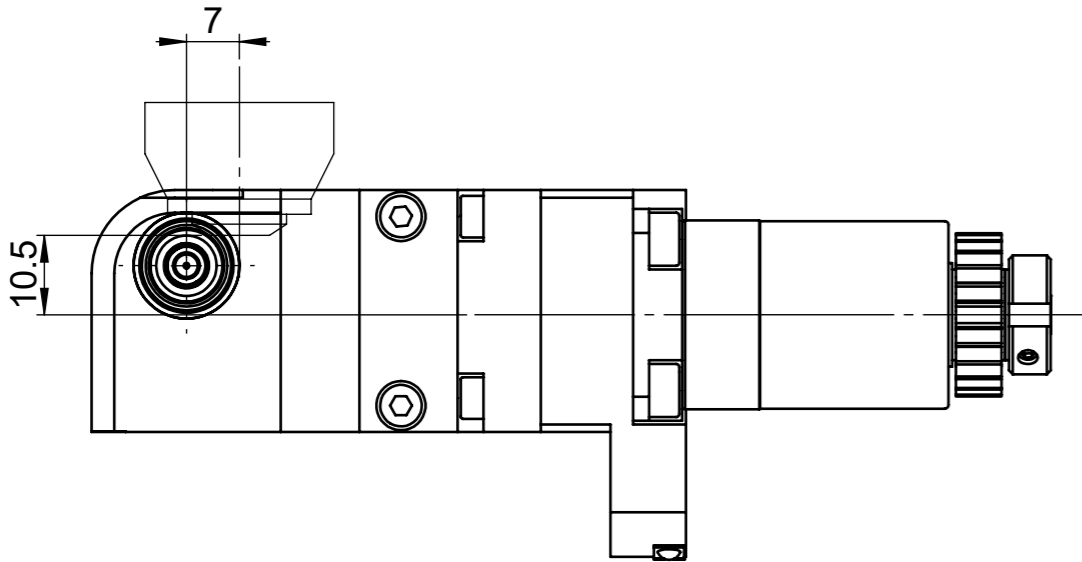

Porte-outil de taillage	© <small>The reproduction, distribution and utilization of this document as well as the communication of its contents to others without express authorization is prohibited. Offenders will be held liable for the payment of damages. All rights reserved in the event of the grant of a patent, utility model or design.</small>	CITIZEN			
		Echelle	Créé	Nogueira	14.01.2026
		1:1	Validé	Borgeaud	27.05.2026
0100-SH035-RAD000-1S02 PR	Révision	A			PCM Precision Tooling SA +41 21 967 33 66 CH-1844 Villeneuve www.pcm.ch