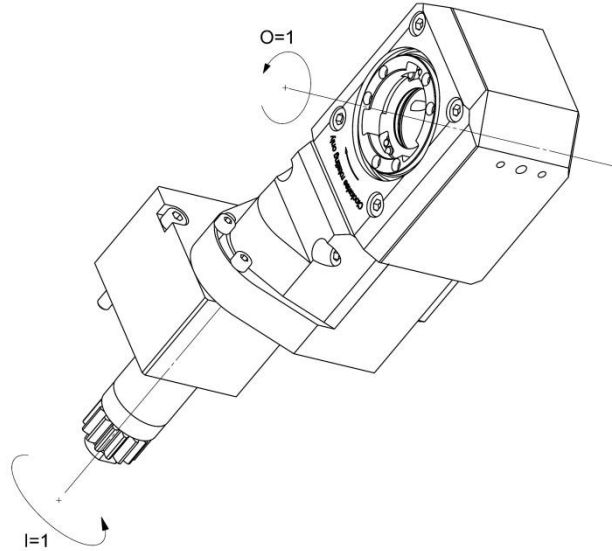
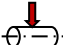

LSW-420

Machine: CITIZEN Cincom
Type: M416-VIII
Emplacement, N°: T06-07/T07-08/T08-09
Travail sur: Broche principale
Type de travail: 
 n_{\max} : 8'000 [rpm]
 $i (n_i / n_o)$: 1 / 1
Attachement: Tête porte-plaquettes

Sans refroidissement

Infos:

- Inclinaison : 16°

- Têtes compatibles avec fixation rapide : Gloor (couteaux ronds) et Schwanog (couteaux triangulaires), Ø de passage 12mm

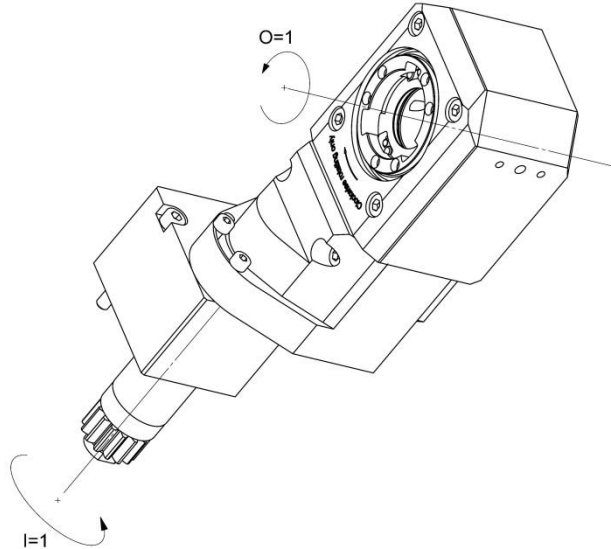
LSW-420

Machine: CITIZEN Cincom

Type: M416-VIII

Location, N°: T06-07/T07-08/T08-09

Work on: Main spindle

Type of work:  n_{max} : 8'000 [rpm] $i (n_i / n_o)$: 1 / 1

Attachement: Whirling head

Without coolant

Infos:

- Inclination : 16°

- Compatible heads with quick attachment : Gloor (round cutters) and Schwanog (triangular cutters), passing \varnothing 12mm

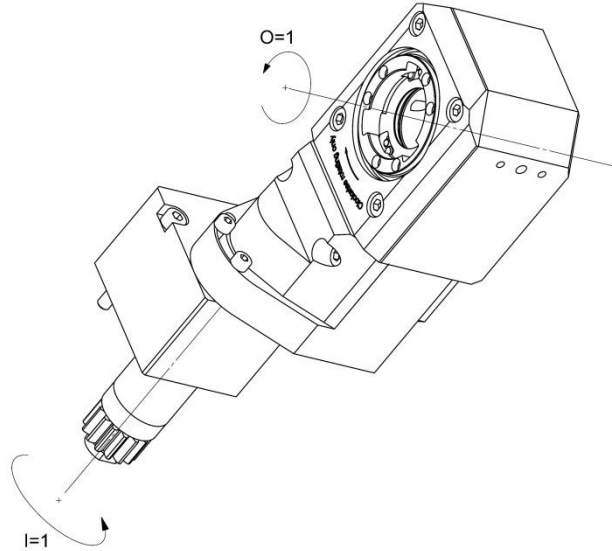
LSW-420

Machine: CITIZEN Cincom

Typ: M416-VIII

Position, N°: T06-07/T07-08/T08-09

Arbeit über: Hauptspindel

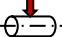
Arbeitstyp:  n_{max} : 8'000 [rpm] $i (n_i / n_o)$: 1 / 1

Befestigung: Wirbelkopf

Ohne Kühlmittel

Infos:

- Neigungswinkel : 16°

- Kompatibel Wirbelköpfe mit Schnellbefestigung : Gloor (Zirkularplatten) und Schwanog (Dreikantplatten), DurchführungsØ 12mm

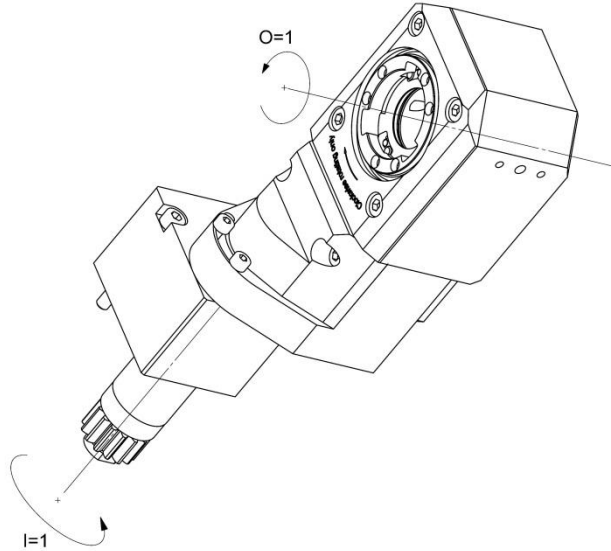
LSW-420

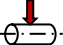
Macchina: CITIZEN Cincom
Tipo: M416-VIII
Posizione, N°: T06-07/T07-08/T08-09
Lavoro al: Mandrino principale
Tipo di lavoro: 
 n_{max} : 8'000 [rpm]
 $i (n_i / n_o)$: 1 / 1
Ataccamento: Disco per discofilletatura

Senza refrigerante

Informazioni:

- Inclinazione : 16°

- Dischi compatibili con attacchi veloce : Gloor (inserti circolari) e Schwanog (inserti triangolare), Ø di passaggio 12mm