

GSS1036-DEC

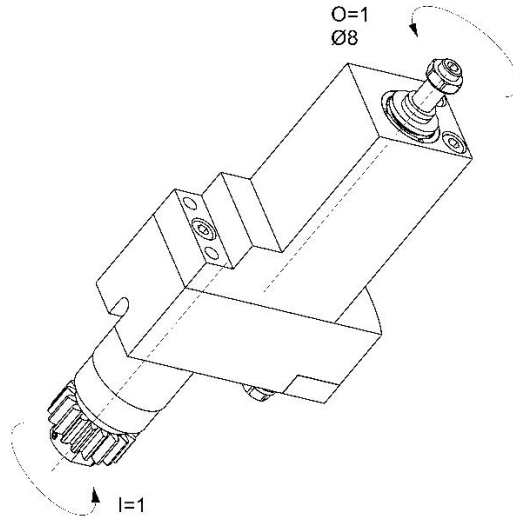

Machine: CITIZEN

Type: A20/A32 / L220/L32 / M32

Emplacement, N°: Upper gang tool post

Travail sur: Broche principale

Type de travail: 

i (n_i / n_o): 1 / 1

Attachement: Arbre Ø 8

Sans refroidissement

Infos:

Diamètre de la fraise. : Ø50mm max.

Epaisseur de la fraise : 15.5mm max.

GSS1036-DEC

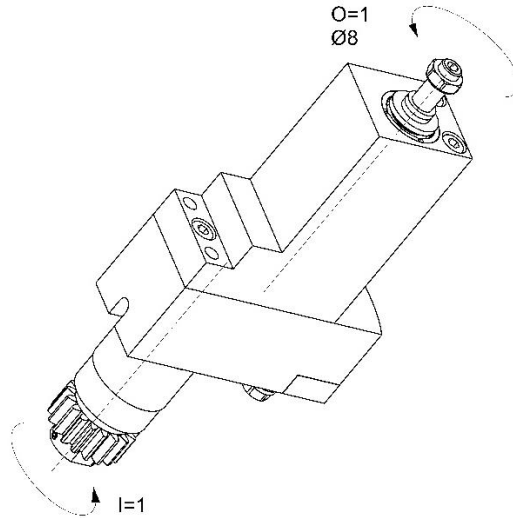

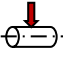
Machine: CITIZEN
Type: A20/A32 / L220/L32 / M32
Location, N°: Upper gang tool post
Work on: Main spindle
Type of work: 
i (n_i / n_o): 1 / 1
Attachement: Arbor Ø 8

Without coolant

Infos:

Diameter of the mill : Ø50mm max.

Width of mill cutter : 15.5mm max.

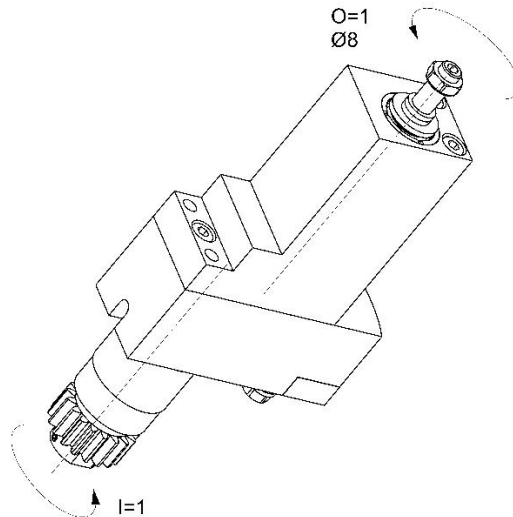
GSS1036-DEC

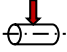
Maschine: CITIZEN
Typ: A20/A32 / L220/L32 / M32
Position, N°: Upper gang tool post
Arbeit über: Hauptspindel
Arbeitstyp: 
i (n_i / n_o): 1 / 1
Befestigung: Welle Ø 8

Ohne Kühlmittel

Infos:

Fräserdurchmesser : Ø50mm max.

Breite des Fräasers : 15.5mm max.