

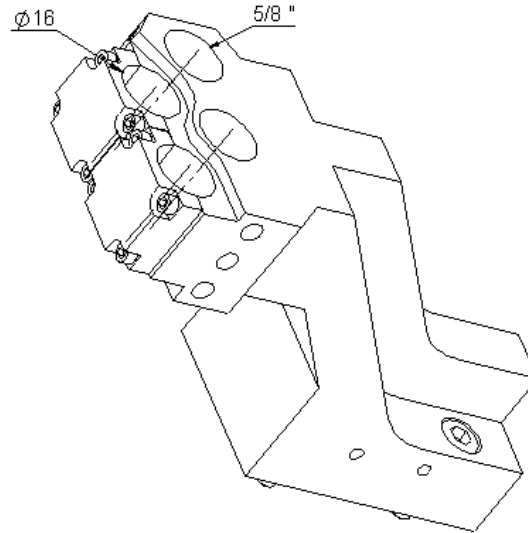

QDF3111-HF

Machine: CITIZEN

Type: R504

Emplacement, N°: Back gang tool post

Travail sur: Broche principale / Broche de reprise

Type de travail: i (n_i / n_o): -

Attachement: 2x Ø5/8 " (15.875 mm) + 2x Ø16 mm HF

Sans refroidissement

Infos:

Pour MHF-16 ETA6/80

La broche haute fréquence peut usiner sur la poupée principale et la contre-poupée.

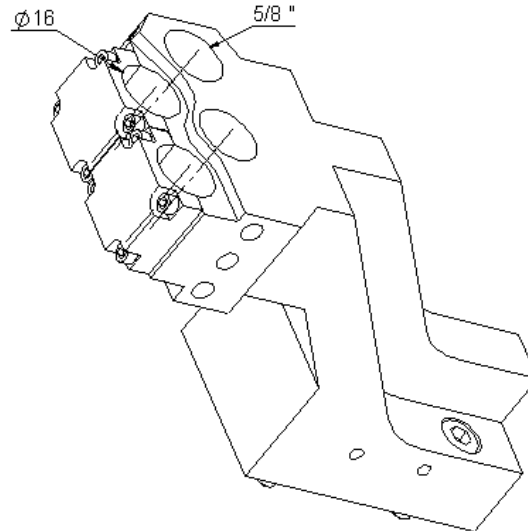
QDF3111-HF

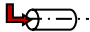
Machine: CITIZEN
Type: R504
Location, N°: Back gang tool post
Work on: Main spindle / Back spindle
Type of work: 
i (n_i / n₀): -
Attachement: 2x Ø5/8 " (15.875 mm) + 2x Ø16 mm HF

Without coolant

Infos:

For MHF-16 ETA6/80

The high speed spindle can machine on the main headstock and the tailstock

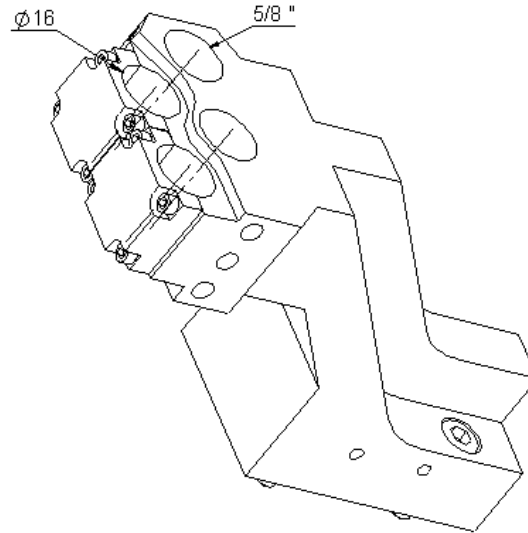
QDF3111-HF

Machine: CITIZEN

Typ: R504

Position, N°: Back gang tool post

Arbeit über: Hauptspindel / Abgreifspindel

Arbeitstyp: i (n_i / n_o): -Befestigung: 2x $\varnothing 5/8''$ (15.875 mm) + 2x $\varnothing 16$ mm HF

Ohne Kühlmittel

Infos:

Für MHF-16 ETA6/80

Die Hochgeschwindigkeitsspindel kann auf dem Hauptspindelstock und dem Reitspindelstock arbeiten.