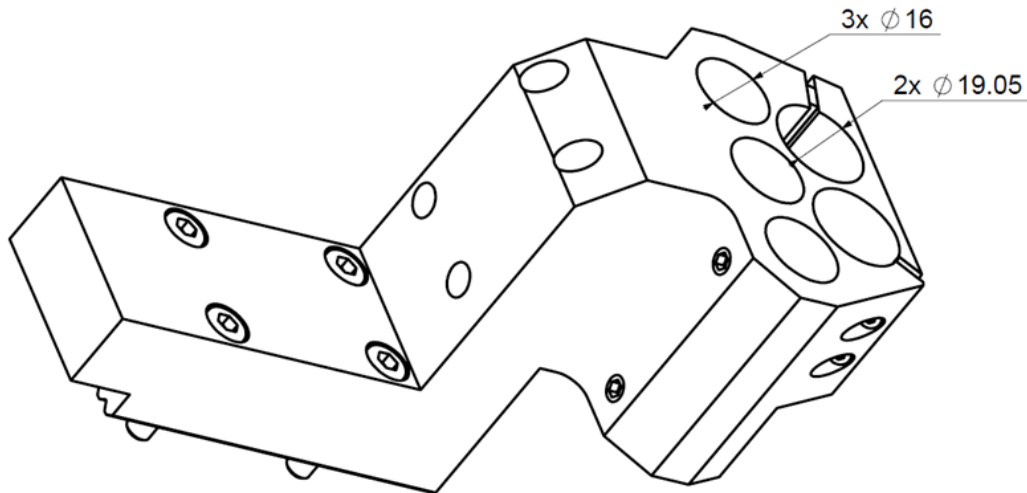

P03-GDF-519-HF-AP

Machine: TSUGAMI

Type: P01/P03

Emplacement, N°: Front gang tool post / Rear gang tool post

Travail sur: Broche principale / Broche de reprise

Type de travail: i (n_i / n_o): -

Attachement: 3x Ø16 / 2x Ø19.05

Sans refroidissement

Infos:

Seulement pour la plaque Applitec Modu-Line avec un espacement de 12 mm.

Les Ø19.05 sont faits pour la broche haute fréquence Nakanishi BM-319.

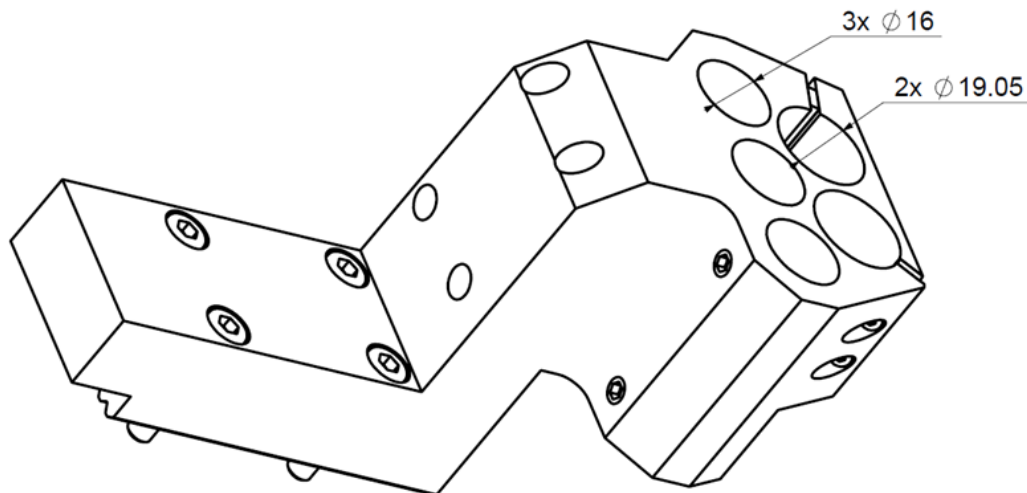
P03-GDF-519-HF-AP

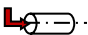
Machine: TSUGAMI
Type: P01/P03
Location, N°: Front gang tool post / Rear gang tool post
Work on: Main spindle / Back spindle
Type of work: 
i (n_i / n₀): -
Attachement: 3x Ø16 / 2x Ø19.05

Without coolant

Infos:

Only for Applitec Modu-Line plate with a 12 mm spacing.

Ø19.05 are made for Nakanishi BM-319 high frequency spindle.

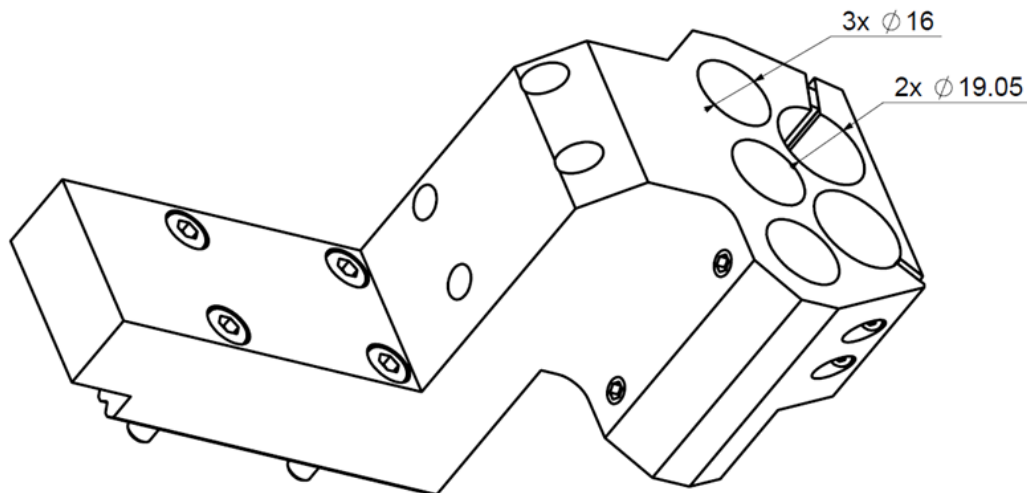
P03-GDF-519-HF-AP

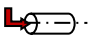
Maschine: TSUGAMI
Typ: P01/P03
Position, N°: Front gang tool post / Rear gang tool post
Arbeit über: Hauptspindel / Abgreifspindel
Arbeitstyp: 
i (n_i / n_o): -
Befestigung: 3x Ø16 / 2x Ø19.05

Ohne Kühlmittel

Infos:

Nur für Applitec Modu-Line Platte mit 12 mm Abstand.

Ø19,05 sind für Nakanishi BM-319 Hochfrequenzspindel gemacht.